

EN

User Manual

WASHING MACHINE

# User Manual

W0D129DJ

freggia





<b>CHAPTER-1:</b>	<b>BEFORE USING THE APPLIANCE</b>	
•	Correct Usage	6
•	General warnings	8
•	Safety warnings	12
•	Packaging and Environment	18
•	Savings Information	19
<b>CHAPTER-2:</b>	<b>OVERVIEW OF YOUR DEVICE</b>	
•	General Appearance	20
•	Technical Specifications	22
<b>CHAPTER-3:</b>	<b>INSTALLATION</b>	
•	Removing transportation safety screws	23
•	Adjusting Adjustable Stays	26
•	Electrical connection	28
•	Water inlet hose connection	29
•	Water discharge connection	31
<b>CHAPTER-4:</b>	<b>INTRODUCTION OF CONTROL PANEL</b>	32
•	Detergent drawer	33
•	Programme knob	35
<b>CHAPTER-5:</b>	<b>MACHINE SETTINGS</b>	
•	Day time	36
•	Select language	38
•	Set economic time zone	40
•	Volume setting	43
•	Screen brightness/ contrast	44
•	Revert to factory settings	45
<b>CHAPTER-6:</b>	<b>PRELIMINARY PREPARATION FOR LAUNDERING</b>	
	Separating your laundry	47
	Putting laundries in the machine	48
	Detergent selection and adding detergent to the machine	50
	Operating your machine	51
	Program selection	52
	Stain selection	53
	Stain level selection	55
	Auxiliary functions	56
	Memory	66
	Start/stand-by button	73
	Stopping program / Adding laundry / Cancelling program	75
	Program end	76
	Key lock	77
	Half load sensing system	79
	DoubleJet	80

<b>CHAPTER -7:</b>	<b>PROGRAM TABLE</b>	<b>81</b>
<b>CHAPTER -8:</b>	<b>SELECTING SUB-PROGRAMS</b>	
	Synthetics	92
	Wool	94
	Extras	96
<b>CHAPTER -9:</b>	<b>MAINTENANCE AND CLEANING OF YOUR MACHINE</b>	
	Warning	98
	Water inlet filters	99
	Pump filter	100
	Detergent drawer	102
<b>CHAPTER -10:</b>	<b>FLUSH STOPPER / BODY / DRUM</b>	<b>103</b>
<b>CHAPTER -11:</b>	<b>TROUBLESHOOTING</b>	<b>104</b>
<b>CHAPTER -12:</b>	<b>AUTOMATIC MALFUNCTION WARNINGS AND WHAT SHOULD BE DONE</b>	<b>109</b>
	<b>DESCRIBING ENERGY LABEL AND SAVING ENERGY</b>	<b>114</b>
	<b>DISPOSAL OF YOUR OLD MACHINE</b>	<b>116</b>



- **Definitely read the user's manual.**
  - **Your machine is designed to be used domestically. Commercial use will cause your warranty to be cancelled.**
- 
- Keep your pets away from your machine
  - Please check the packaging of your machine before installation, and the outer surface after the package is opened. Do not operate damaged machines or machines with opened package.
  - Have your machine installed only by authorized service. Any interference to your machine by anyone other than authorized services shall cause your warranty to be void.
  - The appliance is not intended for use by people (including children) with reduced physical, sensory or mental capabilities, or lack of experience and knowledge unless they have been given supervision or instruction concerning use of the appliance by a person responsible for their safety. Children should be supervised to ensure that they do not play with the appliance.

- Use your machine only for laundries that have been specified as suitable for washing by the manufacturer.

- **Before operating the washing machine, remove the 4 transportation screws and rubber spacers from the back of the machine. If the screws are not removed, it may cause heavy vibration, noise and product malfunction, (voiding the guarantee).**

- Your machine is not covered under warranty for faults caused by any kind of external factors (pesticides, fire, etc.).

- Please do not throw away this user manual; keep it for future reference. You or somebody else might need it in the future.

Note: Machinery specifications may vary depending on the product purchased.

- The necessary ambient temperature for your machine's ideal operation is 15-25°.
  - Frozen hoses can tear and explode. In regions where temperature is below zero, ambient temperature might endanger the safe operation of electronic card.
  - Please ensure that the clothes you will place in your machine do not contain any foreign substances (nail, needle, coins, lighter, matches, clip etc.) in their pockets. These foreign substances can damage your machine.
  - Before starting to use your machine, you may call the nearest authorized service and request free-of-charge help for installation, operation and use of your machine.
- It is recommended to perform the first washing operation in 90° Cotton programme and without laundry by inserting 1/2 scale of detergent in 2nd compartment of the detergent drawer.**



- As detergent or softener exposed to air for a long time may cause residues, put your detergent or softener in the detergent drawer at the beginning of every washing.

- It is advised that you unplug your machine and close the water inlet tap if you will not use your machine for a long time.

Also, leaving the door of your machine will prevent the formation of bad odors due to humidity.

- Some water might be left in your machine after the trials and tests conducted due to Quality Control procedures.

This will not damage your machine.

- Remember that packaging materials of your machine may be dangerous for children. Keep the packaging materials in a place where children cannot reach or dispose of them appropriately.

- Keep the small parts found in the document part away from the reach of children and babies.

- Use pre-wash programs only for very dirty laundry.

- Never open the detergent compartment when the appliance is running.

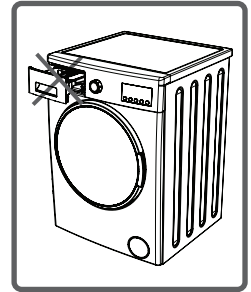

- In case of any breakdown, unplug the appliance first and then turn the tap off. Do not attempt to repair by yourself, always contact for authorized service advice.

- The amount of laundry you put in your washing machine should not exceed the maximum amount indicated.

- Never force the door to open when the machine is running.

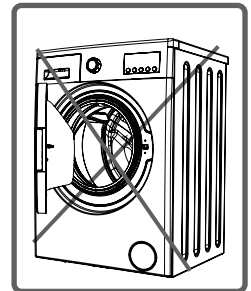

- Washing floury clothes in your machine damages the machine. Do not wash floury clothes in your machine.

- Please adhere to detergent/fabric conditioner manufacturers' advice regarding the use of fabric conditioner or similar products in your machine.
- Set up your machine in a place where its door can be completely opened. (Do not set up your machine in places where its door cannot be fully opened.)
- Set up your machine at locations that can be fully ventilated and could have constant air circulation.

**You must read these warnings. You can thus protect yourself and your beloved ones against fatal injuries and risks.**



**DANGER OF GETTING BURNT!**



Do not touch discharging hose and water during discharging as the appliance may reach high temperatures when running.

## DEATH RISK DUE TO ELECTRICAL CURRENT!



• Do not use multiple receptacles or extension cord.

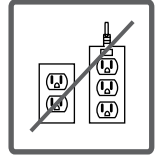

• Do not plug in damaged or torn plugs.

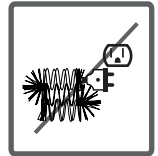

• Never pull the cable when unplugging – always grip the plug itself.

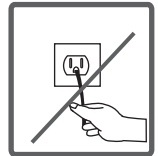

• Do not plug-in or out the plug from the receptacle with wet hands to prevent electrocution!

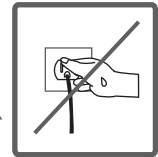

• Never touch the machine with wet hands or feet.



## Flooding risk!



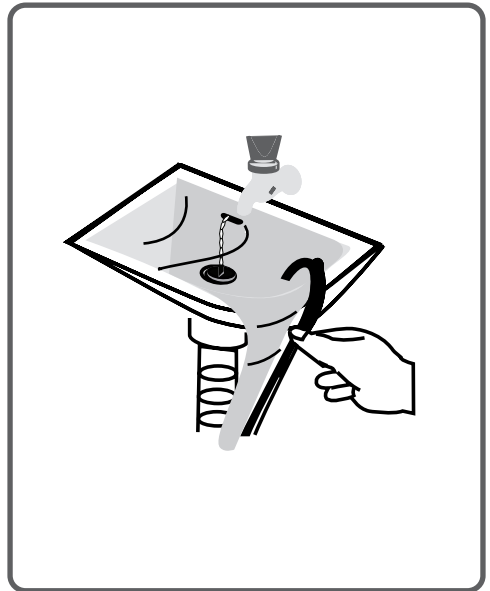

- Check whether the water runs fast or not before placing the discharge hose on the sink.
- Take necessary measures to prevent the slipping of your hose.
- The backfiring force of a hose that is not placed appropriately can displace the hose. Prevent the stopper inside your sink from blocking the sink hole.



## Danger of Fire!



- Do not keep inflammable liquids near your machine..
- The sulphure content of paint removers might cause corrosion. For this reason, never use paint-removing materials in your machine.
- Never use products that contain solvent material (like washing gas) in your machine.  
- Remove all the objects in the pockets of your laundries (needle, paperclip, lighter, matches etc.) when placing them your machine.

**Fire and Explosion risk may occur.**

## Fall and injury hazard!



- Do not climb on your machine. The upper table of your machine may break and you might get injured.
- Tidy the hose, cable and packaging of your machine during installation. You might trip over and fall.
- Do not turn your machine upside down, or on its side.
- Do not lift your machine by holding it from extruding parts (detergent drawer, door). These parts might break and cause you to get injured.
- There's the risk of tripping and injury if the materials like hose and cables are not properly stored after your machine is installed.

**Machine must be carried by 2 people or more.**





## Child safety!



- Do not leave children unattended near the machine. Children might lock themselves up into the machine and death risk might occur.

- Door glass and surface might be extremely hot while your machine operates. Thus, especially touching the machine might give damage to the skins of children.

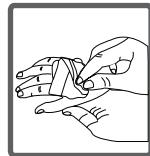

- Keep packaging material away from children.

- Poisoning might occur if the detergent and maintenance materials are consumed, and eyes or the skin might be irritated if they come into contact with the skin. Keep the cleaning materials away from the reach of children.

## Removal of packaging materials

Packaging materials protect your machine from any damage that might occur during transportation. Packaging materials are environment friendly as they are recyclable. Recycling material provides both raw material savings and decreases waste production.

## Disposal of old machine

Electrical or electronic old devices might still contain salvagable parts. So, never throw away your old devices that you do not use into the waste.



Ensure that the parts of your old electronic or electrical devices are reused by giving them to the gathering centres foreseen by related authorities.

**Please ensure your old appliances are kept in an appropriate place for the safety of children until they are taken outside the house.**

Some important information to get more efficiency out of your machine:

- The amount of laundry you put in your washing machine should not exceed the maximum amount indicated.

By this way, your machine shall run in saving mode.

- Not using the pre-wash feature for little and normal-dirty laundry shall save electricity and water.

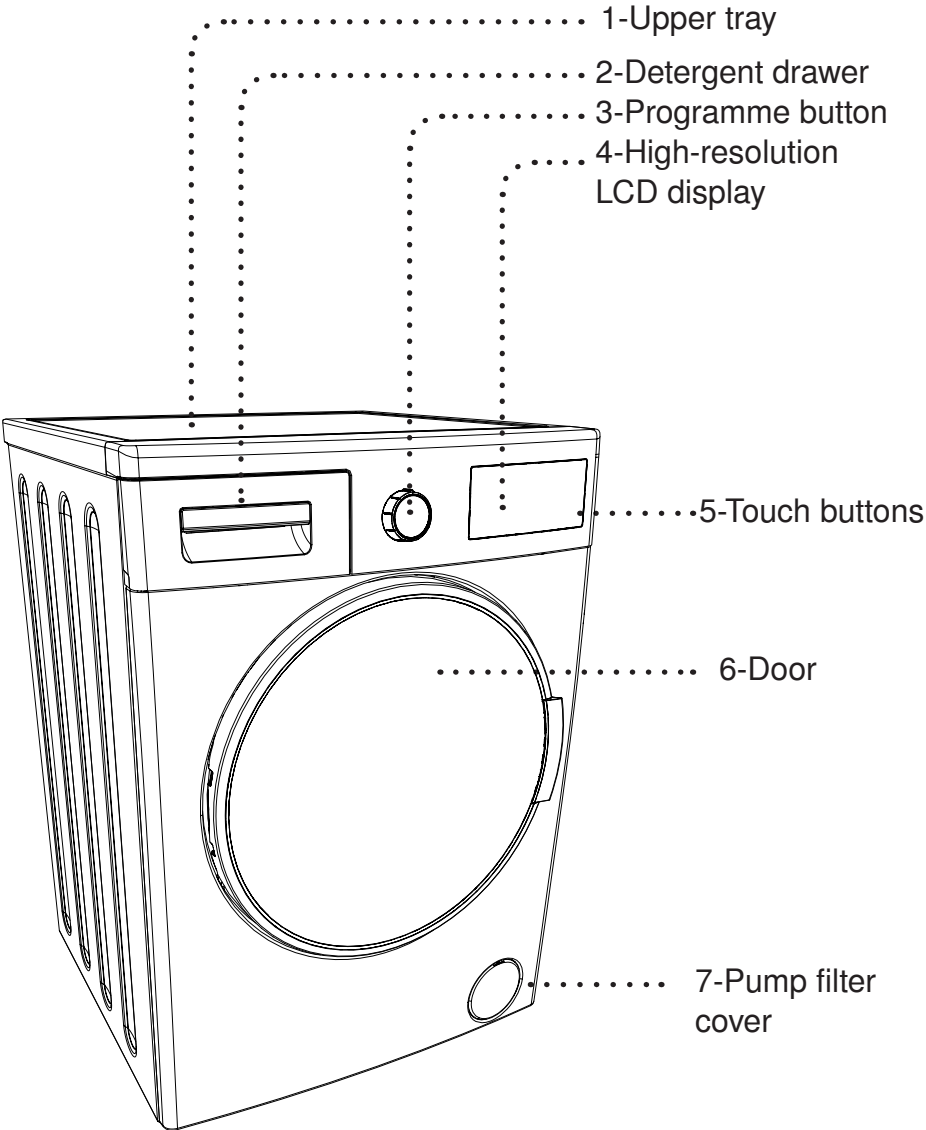

Transportation Safety  
Screw

Water Inlet Valve

Discharging Hose

Power Cable

Transportation Safety  
Screw

Transportation Safety  
Screw

Transportation Safety  
Screw

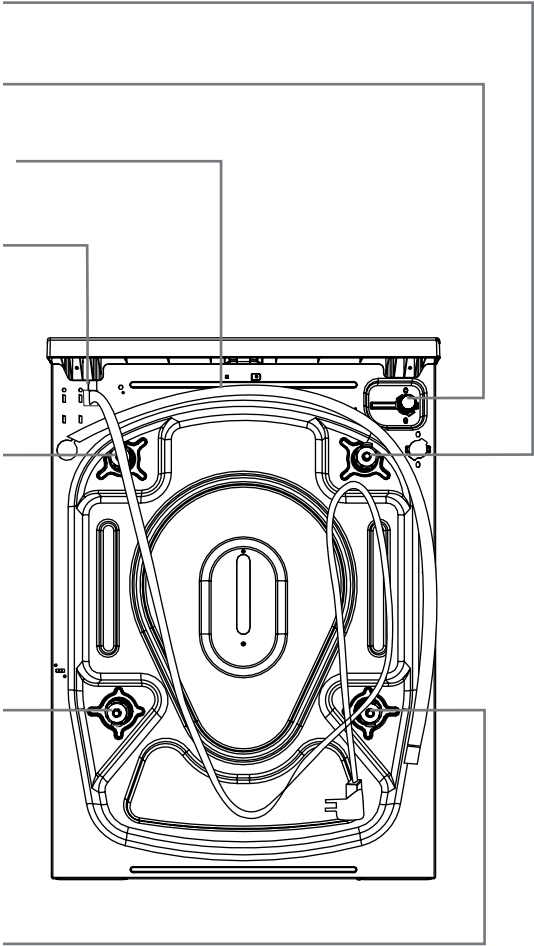

Operating voltage / frequency (V/Hz)	(220-240) V~/50Hz
Total current (A)	10
Water pressure	Maximum: 1 Mpa Minimum : 0.1 Mpa
Total power (W)	2200
Maximum dry laundry capacity (kg)	9
Spinning revolution (rev / min)	1200
Programme number	15
Dimensions (Height x Width x Depth) (mm)	845 x 597 x 587



Before operating the washing machine, remove the 4 transportation screws and rubber spacers from the back of the machine. If the screws are not removed, it may cause heavy vibration, noise and product malfunction, (voiding the guarantee).

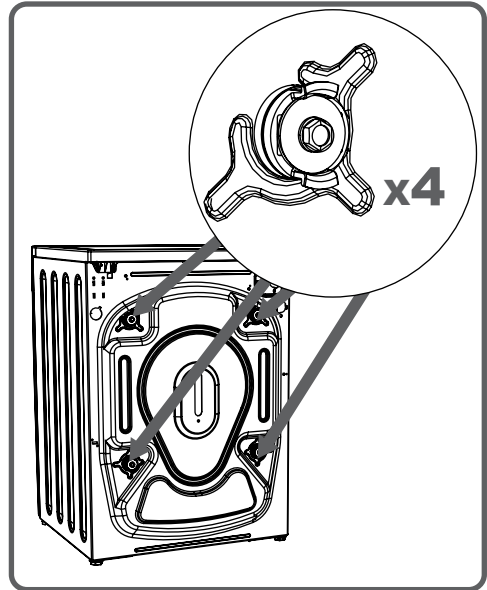

For this reason, transportation safety screws shall be loosened by being rotated in counter-clockwise using an appropriate wrench.

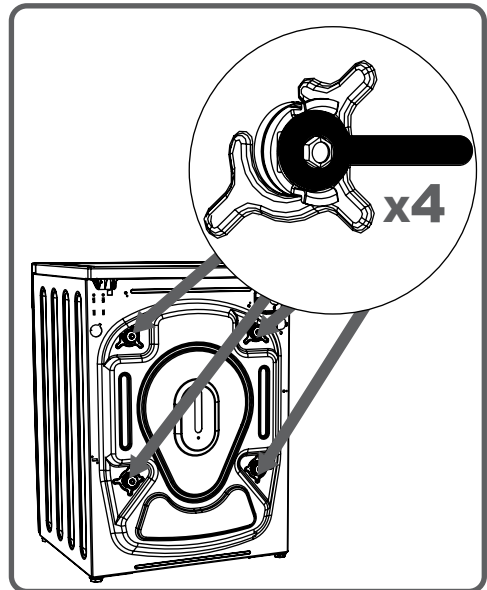

Transportation screws shall be removed by pulling out.

Fit the plastic transportation screw taps delivered in accessories bag to the places where transportation screws have been removed.

The transportation safety screws should be stored to be used in case of transportation.

**NOTE: You should absolutely remove the transportation screws of your machine before the first usage. Faults occurring in the machines operated with transportation screw fitted shall be out of scope of warranty.**

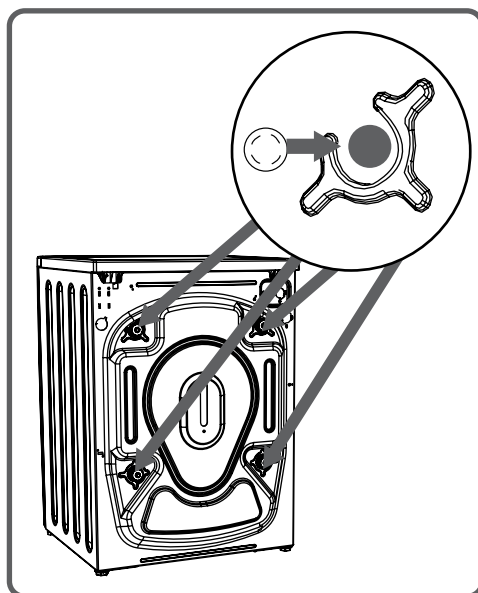
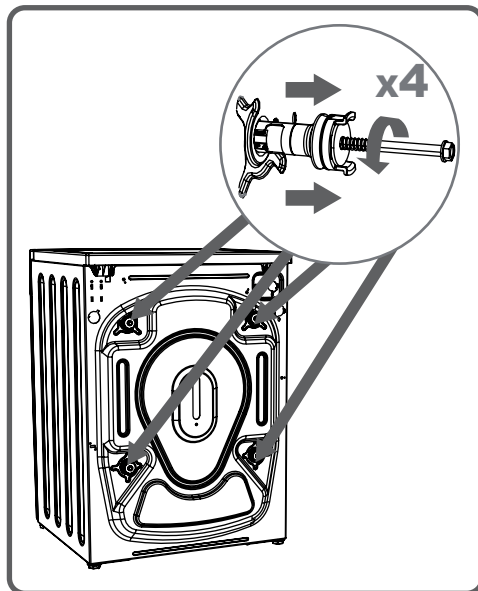



## **Adjusting Adjustable Stays**

- Do not install your machine on a carpet or such grounds that would prevent the ventilation of its base.
- To ensure silent and vibration-free operation of your machine, it should be deployed on a non-sliding and firm ground.
- You can adjust the balance of your machine through the stays.
- Loosen the plastic adjustment nut.

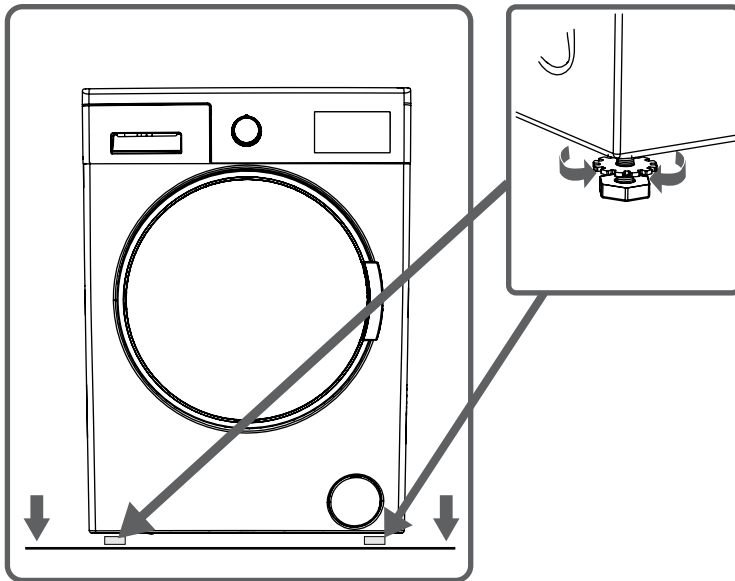

- Adjust the stays upward and downward by rotating them.
- After maintaining the balance, compress the plastic adjustment nut upward again.

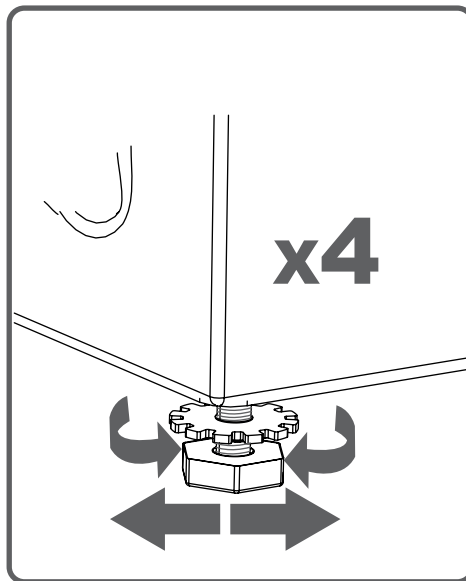

• Never put cardboard, wood or suchlike materials under your machine if you are intending to stabilize the distortions on the ground.



• When cleaning the ground, on which your machine rests, be careful not to disorder stays stabilization.

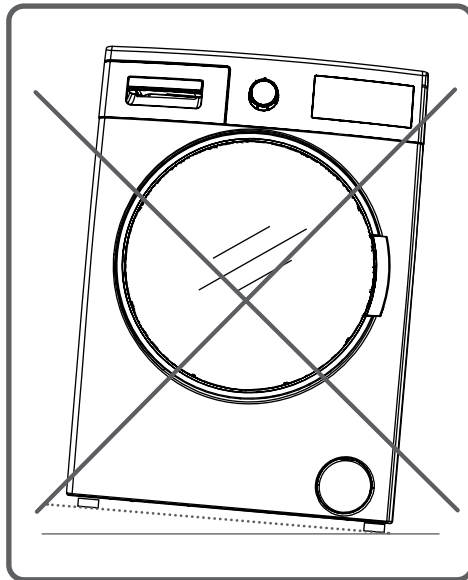

- Your washing machine is set to 220-240V and 50Hz.

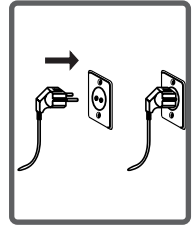

- The mains cord of your washing machine is equipped with a specific earthed plug. This plug should always be inserted to a earthed socket of 10 amps. The current value of the fuse should be 10 amps.

Fuse current value of the power line connected to this plug should also be 10 amperes. If you don't have such a receptacle and fuse confirming with this, please have it done by a qualified electrician.

- We do not take the responsibility of the damages that occur due to ungrounded usage.

**NOTE: Operating your machine under low voltage will cause the life cycle of your machine to be reduced and its performance to be restricted.**

- Your machine may have either a single inlet (cold) or double water inlets (cold/hot) based on its specifications.

White-capped hose should be connected to cold water inlet and red-capped hose to hot water inlet (applicable for machines with double water inlets).

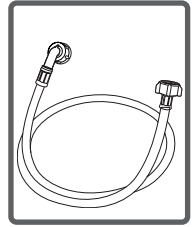

- To eliminate water leakages in points of contact, 1 or 2 nuts are provided in the hose package (applicable for machines with double water inlets). Fit these nuts to the ends of new water inlet hoses on the side of faucet.

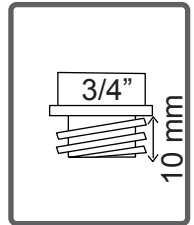

- Mount new water inlet hoses to a 3/4", threaded faucet.

- Connect the white-elbow end of the water inlet hoses to the white-filtered water inlet valve on the rear side of the machine and the red-elbow end to red-filtered one (applicable for machines with double water inlets).

Tighten plastic parts of the junctions using your hand.

In uncertain conditions, have the connection works be done by a qualified plumber.

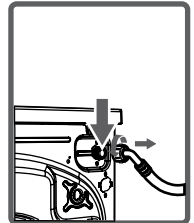

- Flow of water with pressure of 0,1-1 Mpa will allow your machine to operate more efficiently.) (0,1 Mpa pressure means that more than 8 litres of water will flow through a fully-tapped faucet per one minute.)

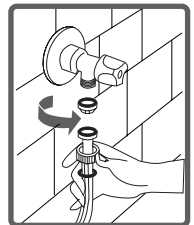

- Ensure that points of contact do not leak by tapping the faucet completely after carrying making the connections.

- Ensure that the new water inlet hoses are not bent, broken, crushed and resized.
- If your machine has double hot water inlets, the temperature of hot water inlet should be maximum 70°C.

**Note: Use only the new water inlet hose coming with your machine while making Water inlet hose connections of your machine. Never use old, used or damaged water inlet hoses.**

- The end of water discharge hose can be fitted to a specific apparatus directly attached to dirty water discharge hole or outlet joint of the basin elbow.
- Never attempt to extend the water discharge hose by jointing.
- Do not put discharging hose of your machine in a vessel, bucket or sink.
- Make sure that the water discharge hose does not bend, buckle, be crushed or extended. Please note:
- The water drain hose should be mounted at a height of minimum 60 cm, maximum 100 cm from the ground.

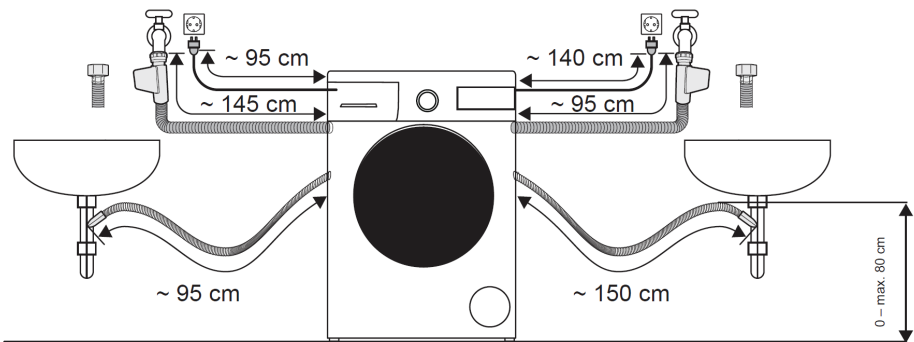
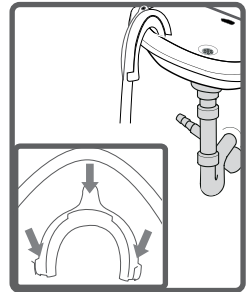
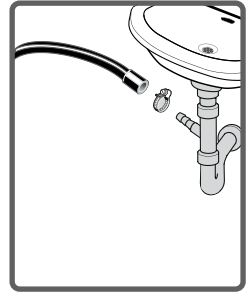

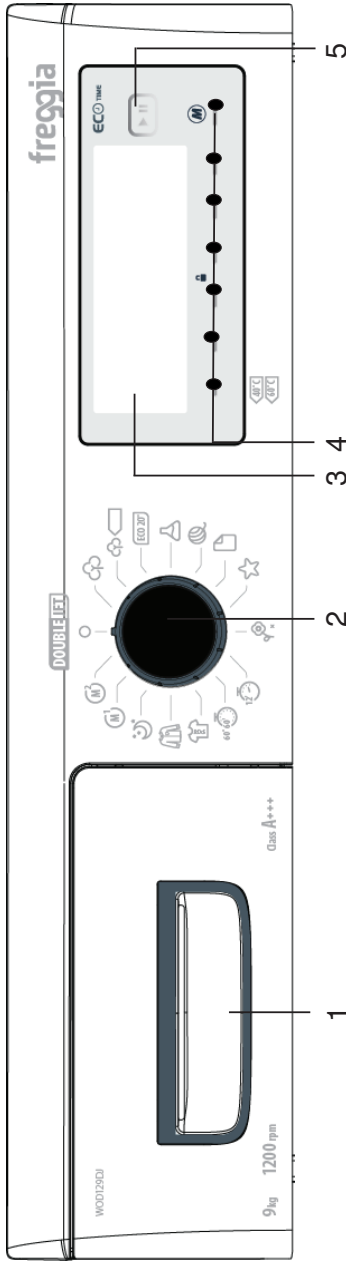

**1-Detergent drawer**

**2-Program button:** You can select the program you want to wash your laundry in with the program button. You may set the program selection operation by rotating the program button in both directions. Ensure that the program button is exactly on the program you want to select.

**3- Info Screen:** In this screen, you can see the features of the washing programs you selected and also have information about machine's status.

**4- Adjustment and additional control buttons:** The buttons on your machine are touch-sensitive. You may just touch them to make a selection.

**5-Start/Stand-by button:** You can start your machine and take it to stand-by with this button.



•••You can use the liquid level determination plate when you want to wash your laundry with liquid detergent. You can use your liquid detergents in all programs without prewashing. Place the liquid detergent aparatus in the second compartment (which is available inside the machine) of the detergent drawer (\*) and set the detergent amount. (Use the recommended amount of liquid detergent by detergent producers). Do not exceed the MAX level, use only for liquid detergent, do not use this aparatus for powder detergent and take it out.)

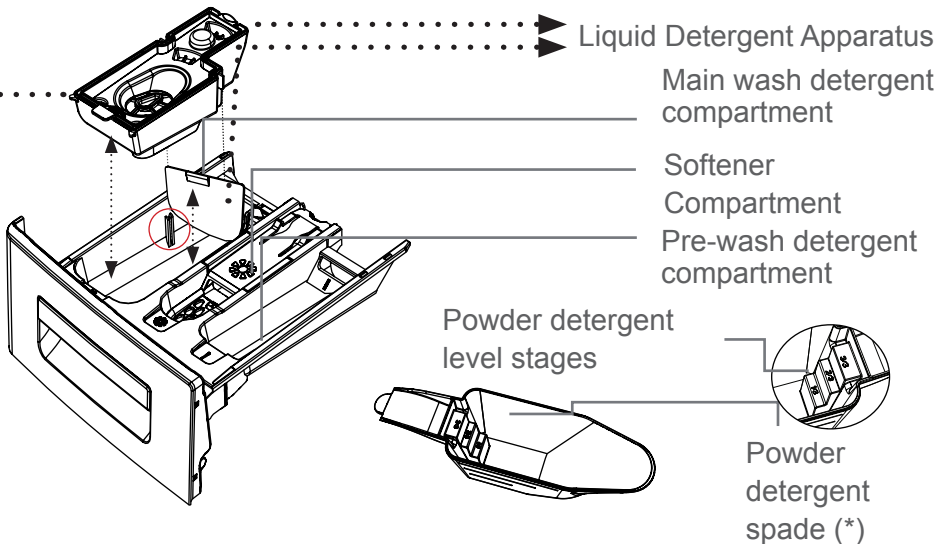
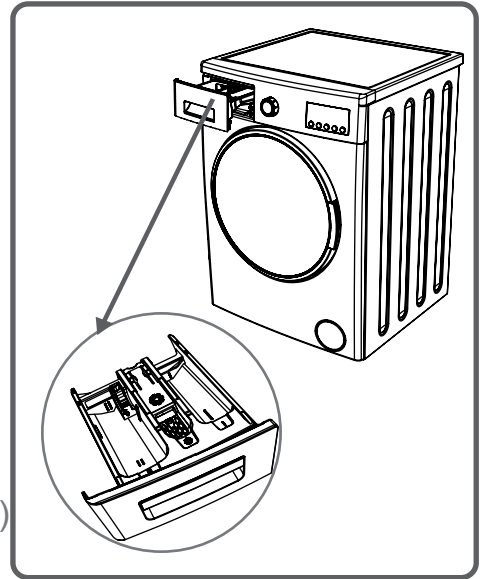

(\*) Machinery specifications may vary depending on the product purchased.

## SECTIONS

### Main wash detergent compartment:

In this compartment, use only materials like detergent (liquid or powder), lime preventer and such can be used. You can find the liquid detergent apparatus inside your machine at first installation. (\*)

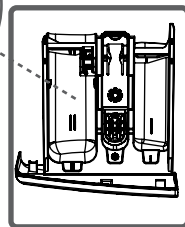
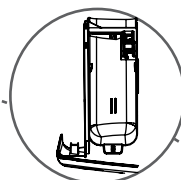

### Fabric conditioner, starch, detergent compartment:

You can use softener for your laundry (recommended amount and type by the producer is recommended). Sometimes the fabric conditioners you use for your wash laundry may remain in this compartment. The reason for this is that the conditioner is not viscous. To prevent this situation, more viscous liquid softeners are recommended to be used or the softener could be thinned and then used.

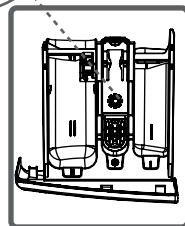
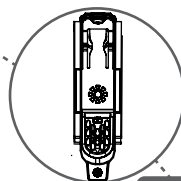

### Pre-wash detergent compartment:

This compartment must only be used when the pre-wash feature is selected. Pre-wash feature is recommended for very dirty laundry.

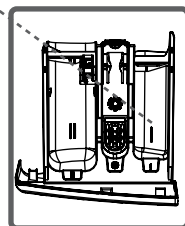
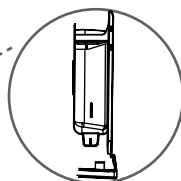

(\*) Machinery specifications may vary depending on the product purchased.

- You can select the programme you want to wash your laundry in through programme knob.
- You may set the programme selection operation by rotating the programme knob in both directions.
- Ensure that the programme knob is exactly on the programme you want to select.

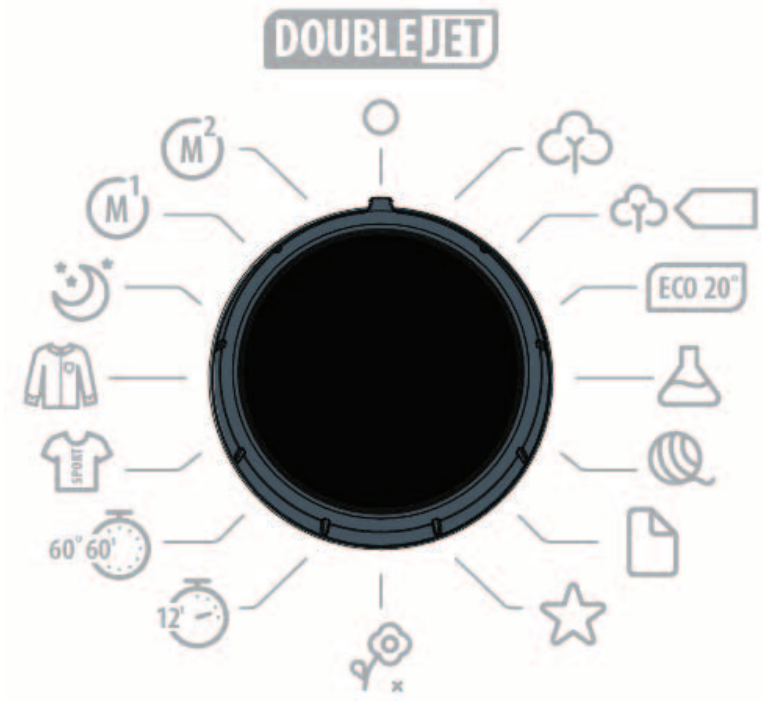

To make the first settings of your machine:

- Plug your machine in.
  - Open the water faucet.
  - Turn the program knob.
- After the logo introduction, your machine will automatically be directed to the time selection setting menu for time selection.

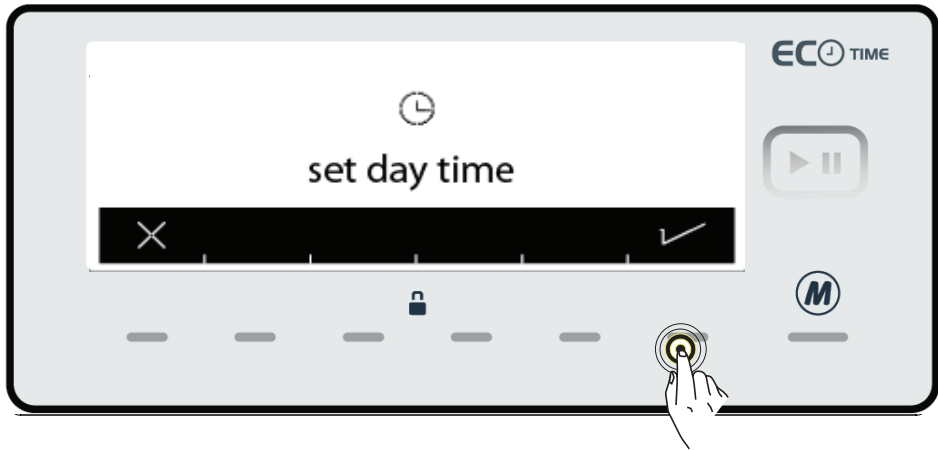

- Your machine will ask your approval for setting the current time. Go to the setting menu by touching the button of ✓ symbol. ✕ symbol button allows you to exit without setting.

**Note:** You must set the current time correctly. If not, it will affect the Operation of other functions related to time.

**Note:** Recorded time information will be reset if you keep your machine unplugged for longer than 15 days. In that case your machine will ask you again for time setting when you turn it back on.

- Please make the current hour and minute settings by touching the buttons of > > symbols

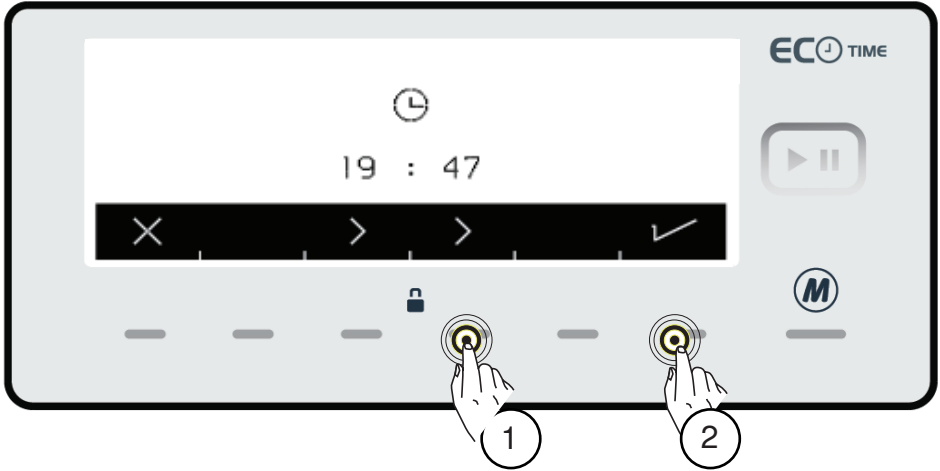

- After setting the current time, approve by touching the button of symbol ✓.

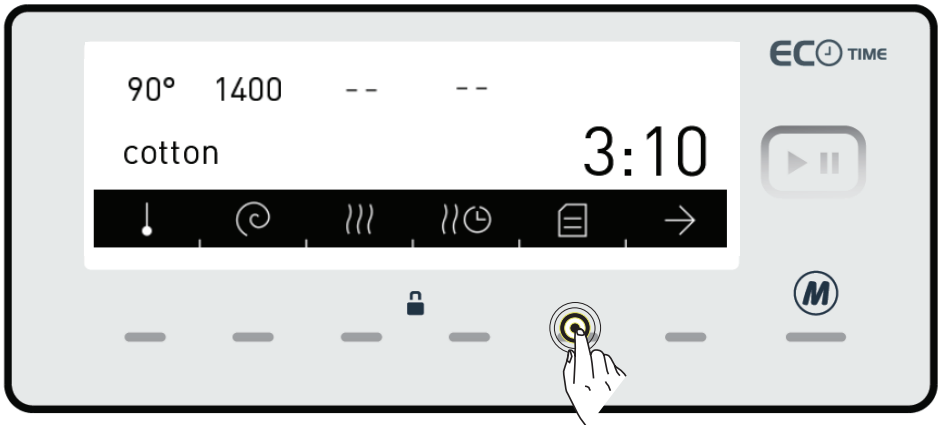

- Your machine will automatically go to the main screen of the program you have selected. Go to the machine settings menu by touching the button of ≡ symbol on this screen.

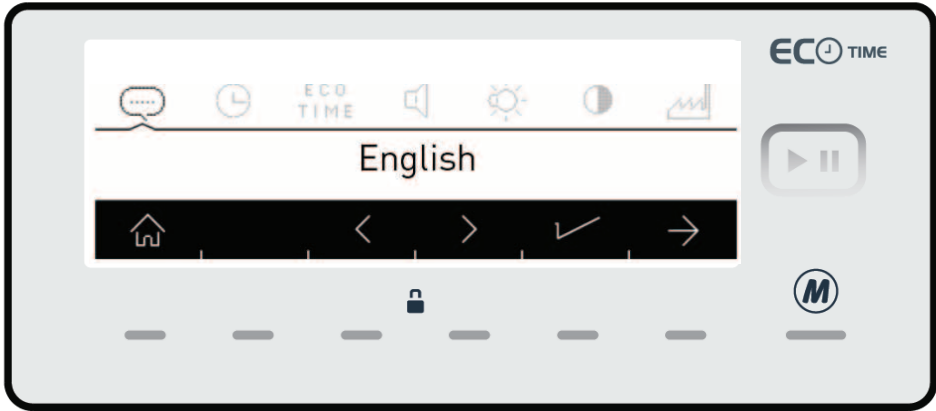

- You can select the language you wish by using the direction buttons < >.

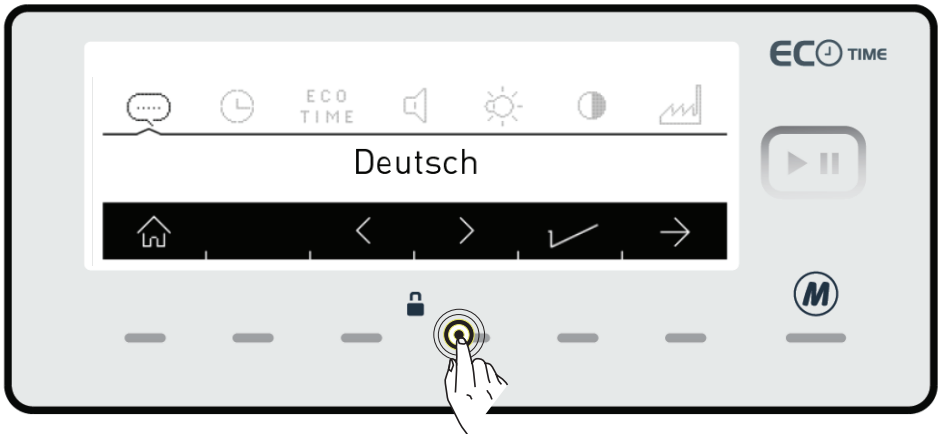

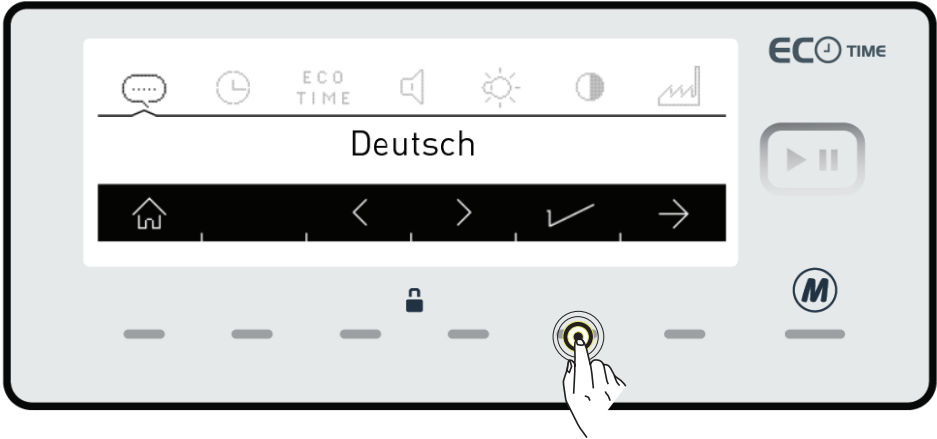

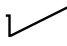
- Touch  button to save the language you selected.
- A question will be asked on the screen for whether you approve the selection.

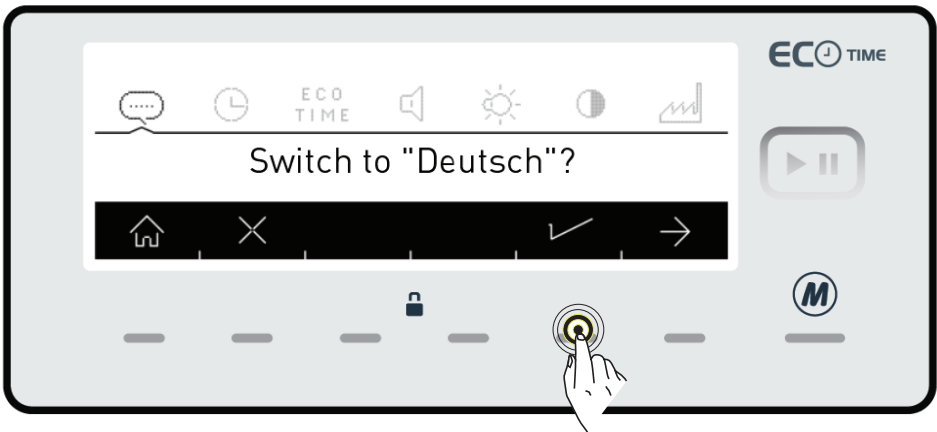



- Touch ✓ button to approve the language change.
- If you think you have selected the wrong language, touch the ✗ button and make the language selection again.
- When you approve the language change, the language you have selected will be active.

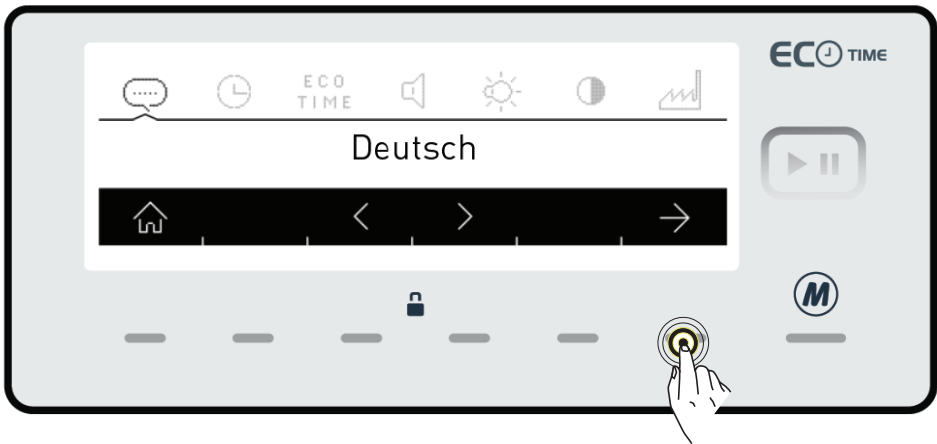

- Go to the → time setting menu of your machine by pressing the button of **ECO TIME** symbol twice.



• The electrical energy consumption cost changes during the day according to the time intervals set by electricity providers. You can learn these intervals from electricity providers and set your eco time running hours, and have your machine run between these hours you determined.

Note: Your mains electricity must be connected to a counter with a smart-counter feature to be able to provide this energy saving.

- Touch the ✓ symbol button to make this adjustment.
- If you want to do it later, touch the ✗ symbol button.

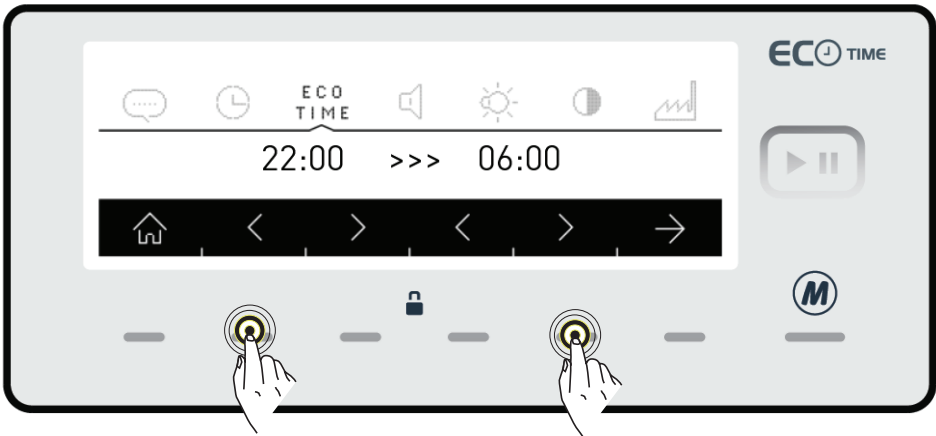

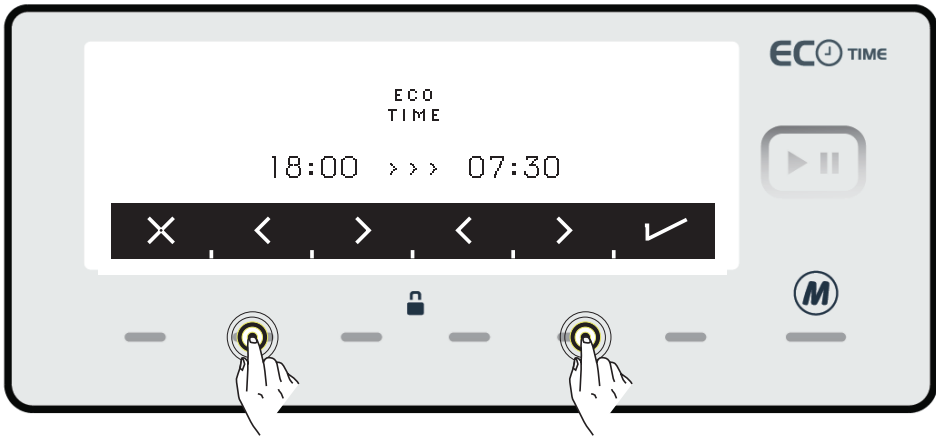

- You can adjust the Eco Time interval by touching the buttons of symbols < > See page 61 to activate the Eco Time interval additional function.

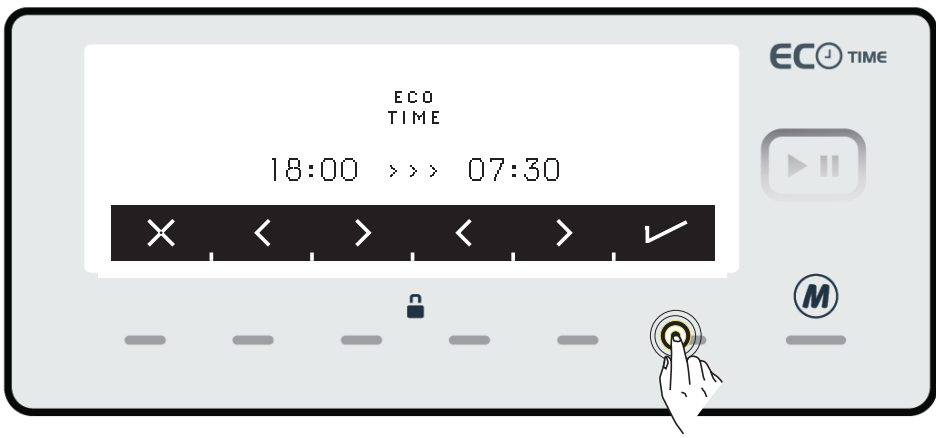

- Approve your selection by touching the ✓ symbol button.



- You can adjust the volume of your machine by touching the buttons of < > symbols.

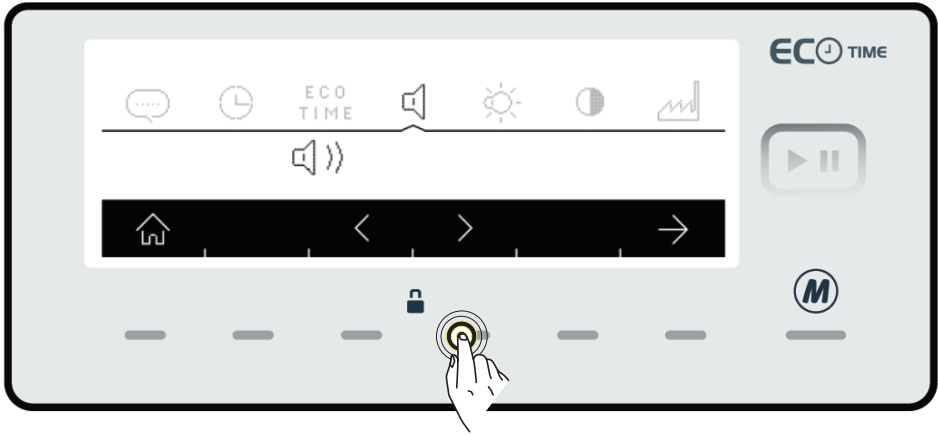

 symbol denotes that the warning sound of your machine is on.



 symbol denotes that the warning sound of your machine is off.

- Adjust the screen brightness of your machine by touching the buttons of → symbol.

- You can adjust the screen brightness of your machine by touching the < > buttons of ☀️ symbols.

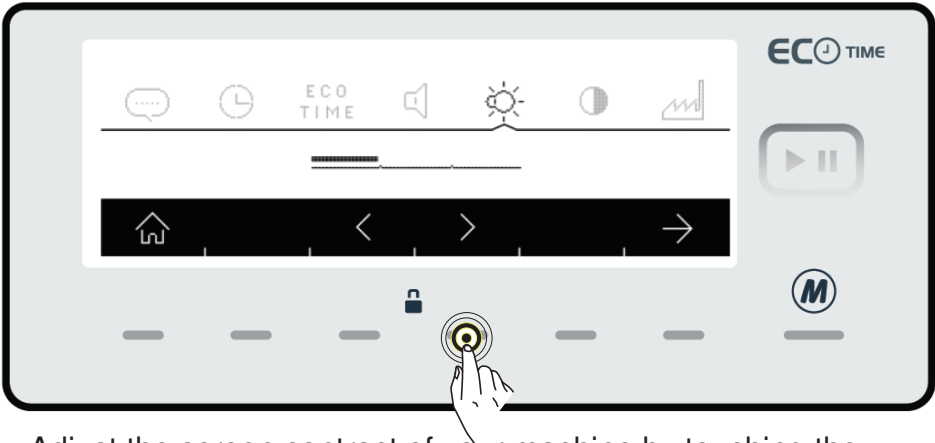

- Adjust the screen contrast of your machine by touching the buttons of → symbol.

- You can adjust the screen contrast of your machine by touching the buttons of < > symbols.

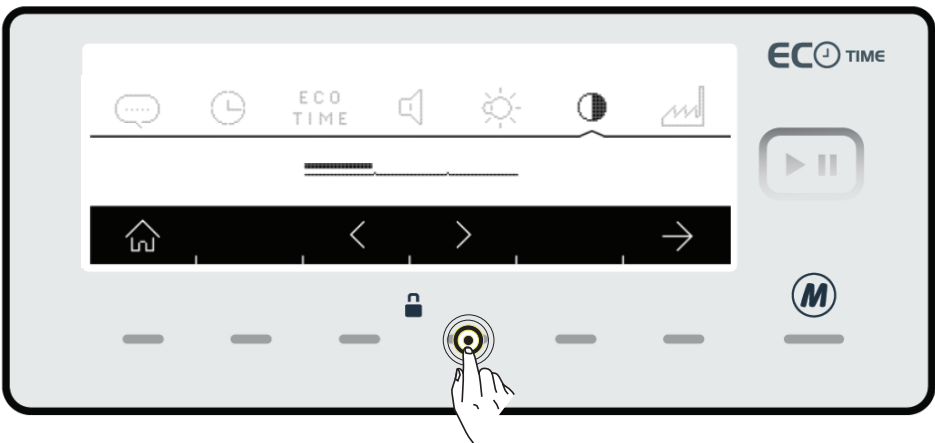

- You can go to revert to factory settings screen by touching the button of → symbol.



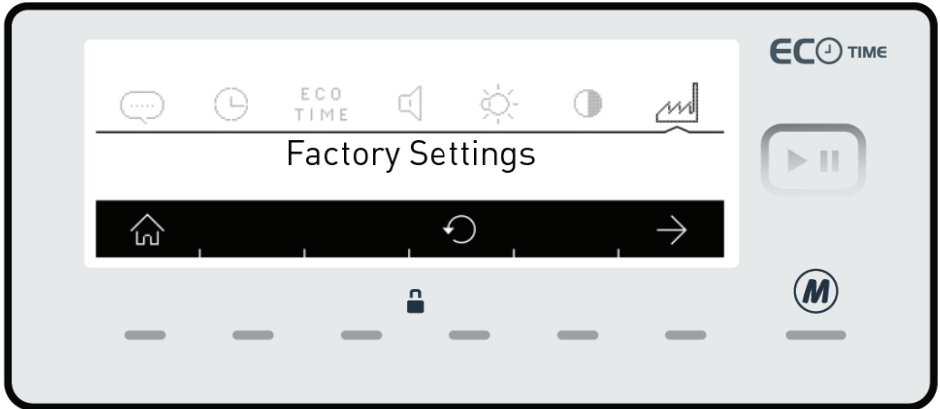

If you want to revert your machine to the factory settings:

- Touch the button of  symbol.

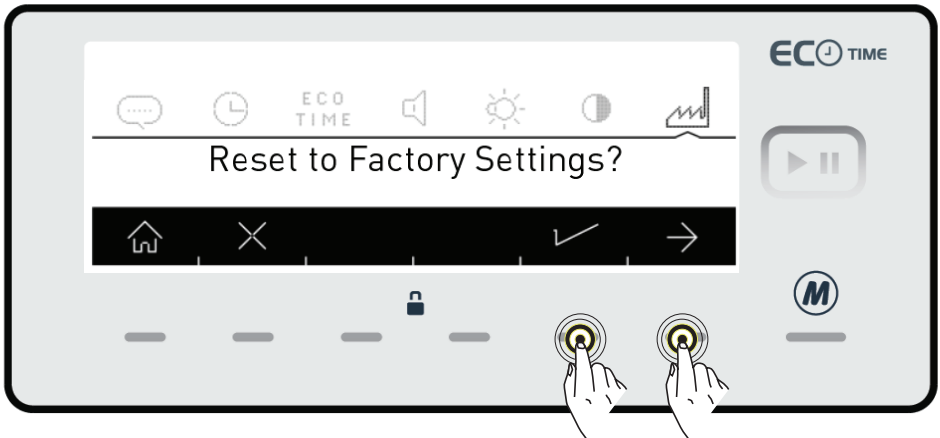

- A question will be asked on the screen for whether you approve the selection.



- A question will be asked on the screen for whether you approve the selection. ✓
- If you want to cancel the selection, touch the button of  symbol.
- **You can return to the main screen by touching the  button.**

• Your laundry has product labels on them that specify their specifications. Wash or dry your laundry according to the specifications on the product label.

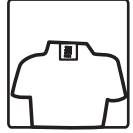

• Separate your laundries according to their types (cotton, synthetic, sensitive, wool etc.), their temperatures (cold, 30°, 40°, 60°, 90°) and degree of contamination (slightly stained, stained, highly stained).



• Never wash your coloured and white laundry together.

Wash your coloured laundries separately in the first washing as they may bleed.

• Ensure that there are no metallic materials on your laundries or in the pockets; if so, take them up.

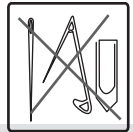

**WARNING: Malfunctions that will occur due to penetration of foreign objects into your machine are not included within the scope of warranty.**



• Zip up and button up your laundries.



• Remove the metallic or plastic hooks of tulle curtains or curtains or place them in a washing net or bag and then muzzle them.



• Turn textiles such as pants, knitwear, t-shirt and sweat suits inside-out.

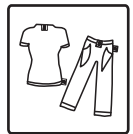

• Wash socks, handkerchief and suchlike small laundries in a washing net.



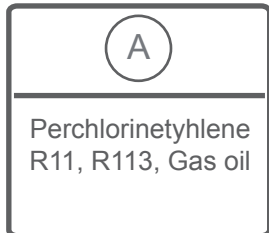
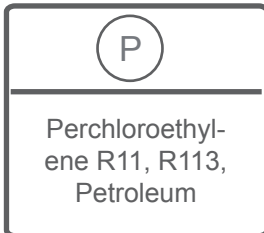
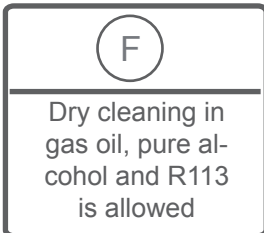
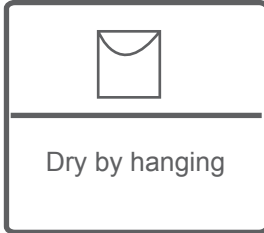
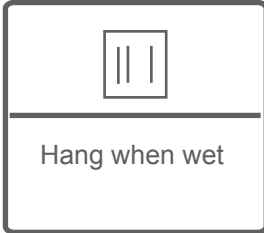
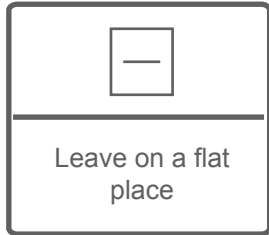
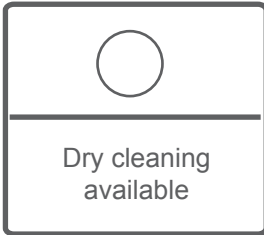
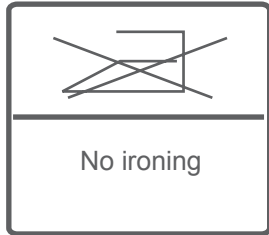
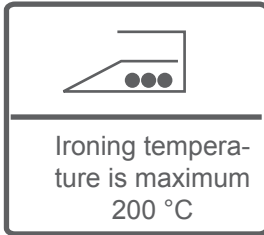
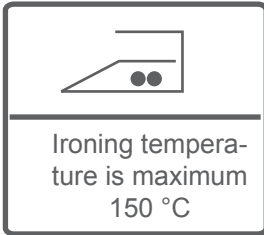
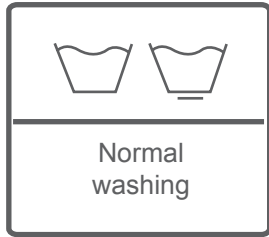
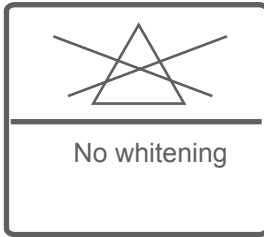

The maximum load capacity of your machine may change according to the program you select. Do not exceed maximum dry loading capacity indicated in the program table for washing programs

- Open the laundry loading door of your machine.

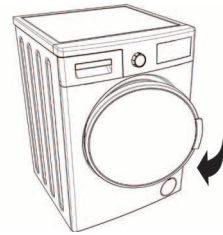

- Check inside the vessel of your machine. There might be laundry left inside from previous washes. If there is, empty your machine before selecting program.

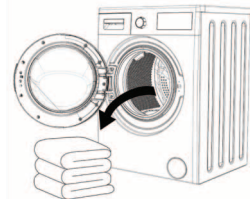

- Spread your laundries in your machine. Fold the objects like quilt, blanket that you will load into the machine as shown below.

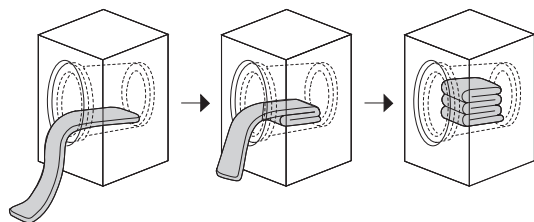



- Put the laundry in separately.
- Ensure that no laundry is stuck between the cover and bellow seal when closing the door of your machine.
- Make sure the door of the machine is closed completely.
- If the door is not completely closed, your machine won't start the washing Operation.

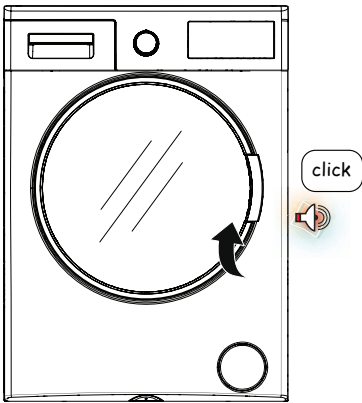

The amount of detergent you will put in your machine will depend on the following criteria:

- Your detergent utilization will be based on the degree of contamination of your laundry. Do not prewash your less stained laundry and put your slight amount of detergent in the 2nd compartment of the detergent drawer.
- Pre-wash feature might be used for your very dirt laundry. If pre-wash will be made, place 1/4 of the detergent you will put in the detergent compartment into the compartment numbered 1 using the detergent spade, and put the remaining 3/4 to the compartment numbered 2.
- Use detergents produced for automatic washing machines in your machine. Adhere to the advice of detergent manufacturers while determining the amount of detergent you will use with your laundry.
- The higher the degree of hardness of the water the more detergent you will use.
- The amount of the detergent you will use will increase as the amount of your laundries increase.
- Put the softener in the softener compartment in the detergent drawer. Do not exceed the MAX level. Otherwise, softener will flow into washing water through flushing.
- Softeners with high density are required to be thinned to a degree before being put in the drawer. Because high-density softener will clog the flush and avoid the flow of the softener.

You can use your liquid detergents in all programs without pre-washing. To do this, place the liquid detergent apparatus inside your machine to the second compartment of the detergent drawer, and fill the liquid detergent not exceeding the max level and in amounts the detergent manufacturer recommends.

(Please see page 33 regarding the location of the liquid detergent apparatus inside the detergent drawer).

- Plug your machine in.
- Open the water faucet.
- Open the machine door.

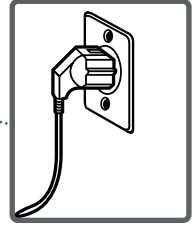

- Spread your laundry in your machine.
- Push the door of your machine to close it until you hear the locking sound.

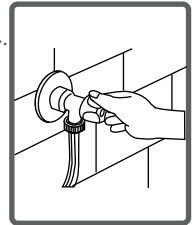

- Select the washing program you desire by the program button.

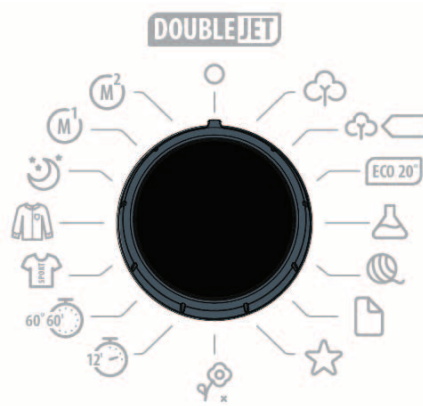

- Program name and features will be shown on the screen.

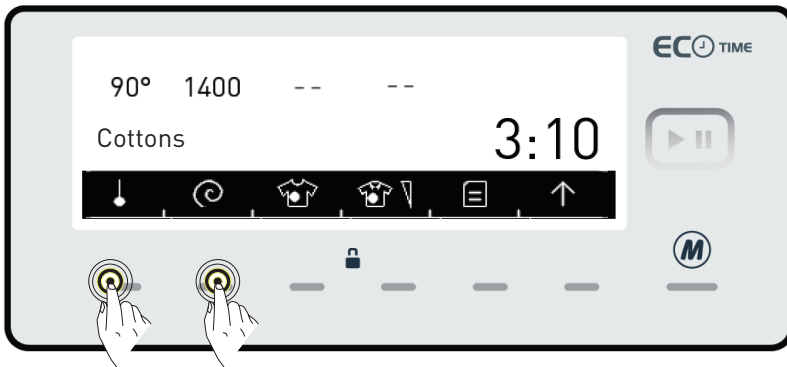

- You can make the temperature adjustment (\*, 20°, 30°, 40°, 60°, 90°) by pressing the button of symbol.
- You can make wringing speed setting (⌀, 400, 600, 800, 1000, 1200, 1400) by touching the button of symbol.



Your machine has additional functions for removing 22 different types of stains.

You can make use of these auxiliary functions according to the stain types on your laundry.

**Warning:** For the stain selection auxiliary function to perform properly, you should not let the stains on your laundry to dry and stick. Remove solid materials beforehand.

**Warning:** Before you start washing the new stains on your laundry, press on the stain once with a cloth. Do not rub!

Your washing machine automatically adjusts the washing temperature, vessel rotation movement and rinse number and duration according to the stain type selected.

For example, the stain removing methods of your machine are as such ;



**Blood stain:** The blood stain auxiliary function combined with the selected washing program will dissolve the laundry with blood stains in cold water prior to the main program and work to clean the stained surfaces, and then your selected washing program will start.

**Egg stain:** Egg stains will be softened in warm water for a certain time to clear the stain, and then the combined washing program will continue to complete the washing cycle.

The stain type selection features in your machine are listed below.

For other stain selections, similar stain removal solutions are available.

For the stain selection to be active, touch the stain selection  symbol button on the screen of your machine. (Picture1)

Determine the stain selection by touching the arrow   symbol buttons. (Picture2)

To approve the selection, activate the stain removal auxiliary washing program you selected by touching the  symbol button on the screen. (Picture2)

Picture 1

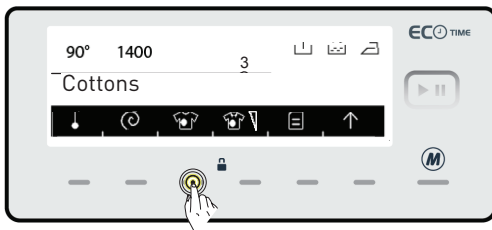

Picture 2

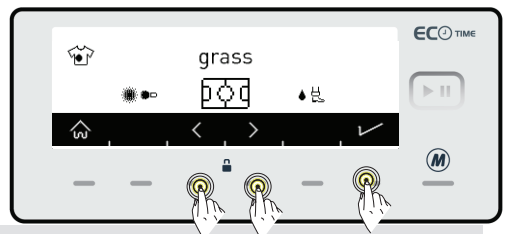



Picture 3

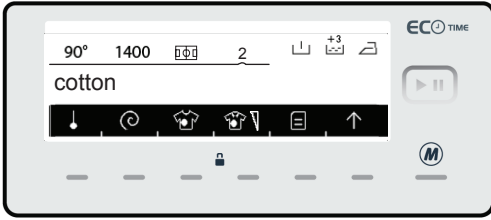

Picture 4

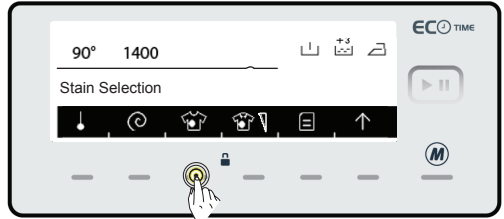

On the screen you will see the symbol for the stain selection you selected. (Picture3)

If you want to cancel the stain selection, you can touch the stain selection symbol button. The warning message that the selection is cancelled will be displayed on the screen for a short duration. "Stain selection"

If you want to re-select the stain removal function re-apply the operations seen in picture 1 and picture 2.

Note: If the desired result is not achieved with the selected stain selection at the end of the wash, you might have selected the wrong stain; please re-apply the washing operation with the correct stain selection to remove the stain.  
Stain selection symbol explanations.

### Stain selection symbol explanation table

1-  blood	8-  Coffee	15-  Cuff grime
2-  Mud	9-  Red Wine	16-  Oil
3-  Socks	10-  Tomatoes	17-  Sauce
4-  Baby food	11-  Tea	18-  Chocolate
5-  Sweat	12-  Fruit	19-  Deodorant
6-  Egg	13-  Grass	20-  Lipstick stain
7-  Ice Cream	14-  Collar grime	21-  Make-up
		22-  Mixed

PROGRAMS	STAIN SELECTION
Cotton	S
Cotton eco	S
*Cotton 60 e	S
*Cotton 40 e	S
Eco 20°	SY
Synthetic	S
*Curtain	S
Wool	SY
*Silk	SY
Duvet	S
Exstra	SY
*Rinse	SY
*Spin	SY
*Drain	SY
*Drum clean	SY
Allergy Safe	S
Rapid 12'	SY
Daily 60° 60'	S
Sports Wear	S
Blouses/Shirts	S
Night Wash	S

S: Selectable    SY: No selection  
\* : Sub-programs



You can change your wash settings according to how dirty your laundry is washed in less or more time, lower or higher temperature. The dirtiness levels are automatically set in certain programs. You can make changes as you like.

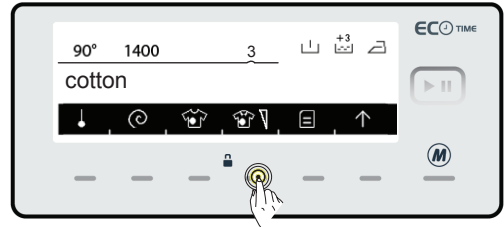

**Note:** If no change occurs when you touch the stain level button , this means there is no stain level selection in the program you have selected.

- 1 Little dirt (no pre-washing)
- 2 Dirty (apply pre-washing if necessary.)
- 3 Very dirty (apply pre-washing if necessary.)



PROGRAMS	DIRTINESS	FACTORY PRESET	SELECTABLE LEVELS	
Cotton	S	Dirty	Very dirty	Little dirt
Cotton eco	S	Dirty	Very dirty	Little dirt
*Cotton 60 e	S	Dirty	Very dirty	Little dirt
<b>*Cotton 40 e</b>	S	Dirty	Very dirty	Little dirt
Eco 20°	SY	Little dirt	NS	NS
Synthetic	S	Dirty	Very dirty	Little dirt
*Curtain	S	Dirty	Very dirty	Little dirt
Wool	S	Dirty	Very dirty	Little dirt
*Silk	S	Dirty	Very dirty	Little dirt
Duvet	S	Dirty	Very dirty	Little dirt
Extra	SY	NS	NS	NS
*Rinse	SY	NS	NS	NS
*Spin	SY	NS	NS	NS
*Drain	SY	NS	NS	NS
*Drum clean	SY	NS	NS	NS
Allergy Safe	S	Dirty	NS	NS
Rapid 12'	SY	Little dirt	NS	NS
Daily 60°60'	S	Dirty	Little dirt	NS
Sports Wear	S	Dirty	Very dirty	Little dirt
Blouses/Shirts	S	Dirty	Very dirty	Little dirt
Night Wash	S	Dirty	Very dirty	Little dirt
S: Selectable SY: No selection * : Sub-programs				

Before starting the program, you can optionally select an auxiliary function.

- Press on the button of auxiliary function you would like to select.

Additional functions may not be active according to the program you selected, the amount of load you put in your machine.

The reasons for not activating:

- It is not compatible with an additional function you have selected previously.
  - If an additional function does not become active when you want to select it while the machine is running; the washing interval that the additional function your want to use would not be completed.
- You can see the program table in pages between 81-91 for the additional functions used in programs.

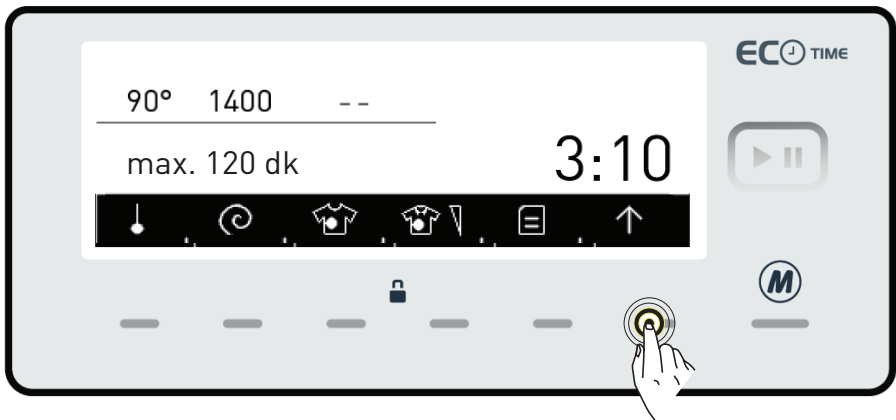

- Touch the  symbol button to go into the auxiliary function indicator.





You can expose your very dirty laundries to prewashing operation prior to main washing by using this additional function. When using this function, you should put detergent in front washing compartment of the detergent drawer.

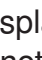

- Touch the  symbol button to activate the pre-wash additional function

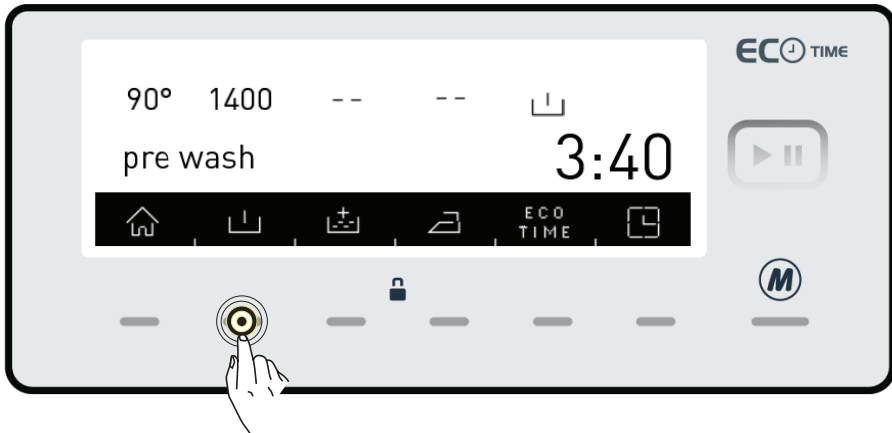
**Note:** When you want to use the pre-wash auxiliary function if  symbol is not displayed on the screen, the washing program you selected does not use this feature.



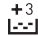

You can make additional rinse or rinses to your laundry by using this additional function. Your machine offers you 3 different rinsing options for this auxiliary function

-  : One additional rinse is made at the end of washing.
-  : Two additional rinses are made at the end of washing.
-  : Three additional rinses are made at the end of washing.

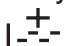
\* If you want to make more than one rinsing, touch the button of  symbol until you see the number of rinses you wish

**Note:** When you want to use the extra rinsing auxiliary function if  symbol is not displayed on the screen, the washing program you selected does not use this feature.

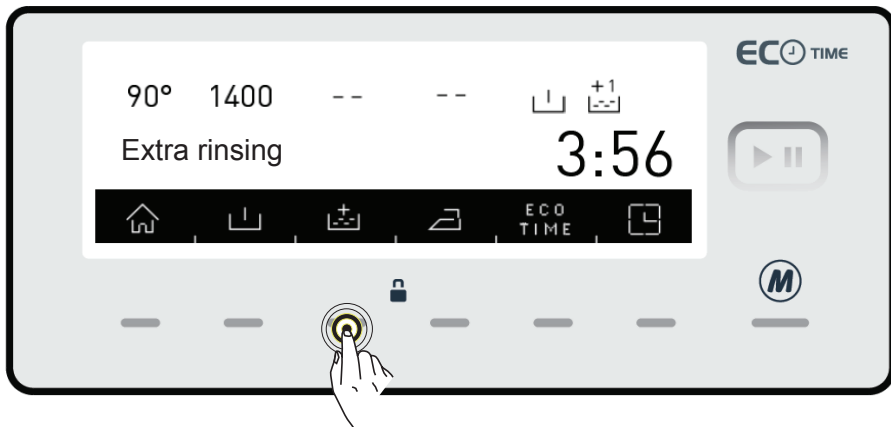

You can make additional rinse operation on your laundry by using this additional function. Your machine will make all rinsing steps with hot water (it is recommended for the laundry worn on sensitive skin, baby clothes, underwear)

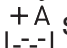
\* To activate the anti-allergic auxiliary function, touch the button of  symbol until you see the  symbol on the screen.

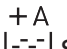

**Note:** If the  symbol is not displayed on the screen when you want to select the anti-allergic additional function,

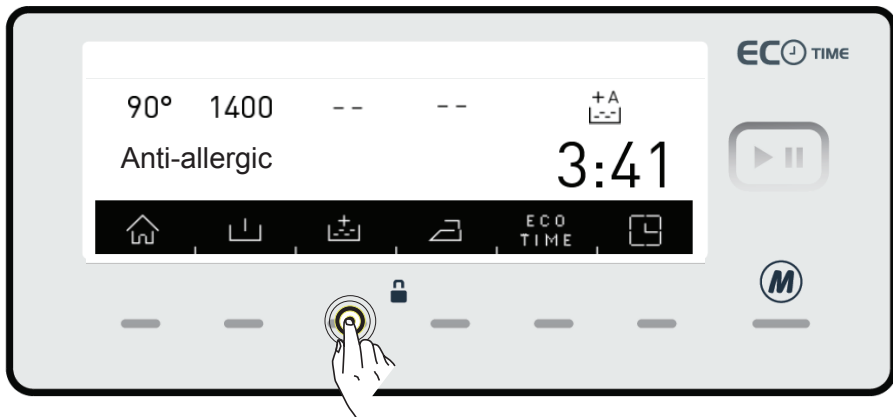
it means that the washing program you selected does not use this feature.





You can enable your laundries to be taken out less wrinkled as the washing operation is completed by employing this auxiliary function.

\* Touch the  symbol button to activate the easy ironing additional function touch the button of  symbol.

**Note:** If the  symbol is not displayed on the screen when you want to select the easy ironing additional function,

it means that the washing program you selected does not use this feature.

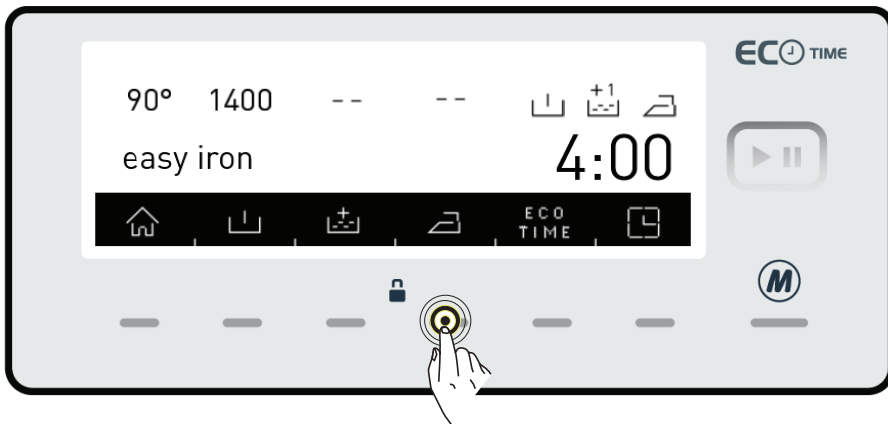

- You must make the Eco Time setting from the settings section for this function to work efficiently. (see page 41)
- If you want to activate the Eco Time function, touch the button of **ECO TIME** symbol.
- You will see **ECO TIME** symbol is activated on the screen.

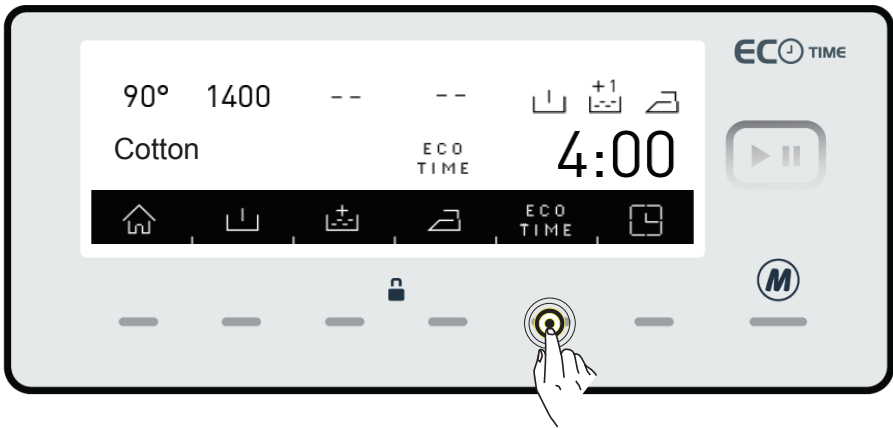

- Eco Time feature will be constantly displayed on the screen until it is shut off. To shut off, Eco time additional function button must be pressed.

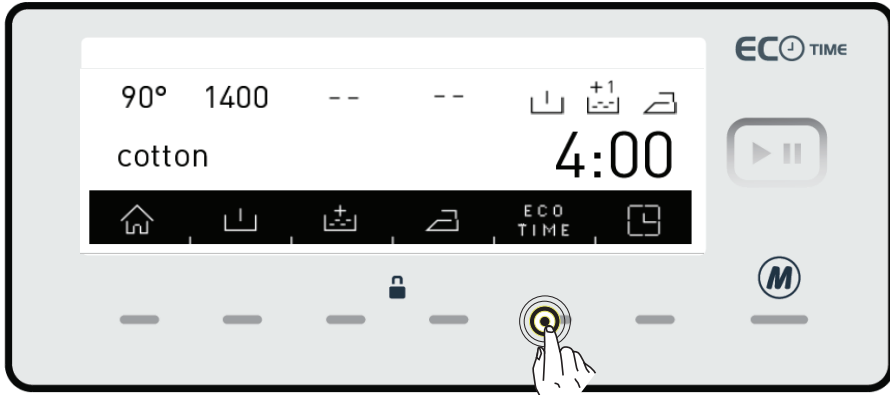

- If you want to run a program while Eco Time feature is active, touch the button of  symbol. The starting time of the program will be automatically delayed for it to run on the economic time interval. Program “starting time” and the program duration will be shown on the display with certain intervals.

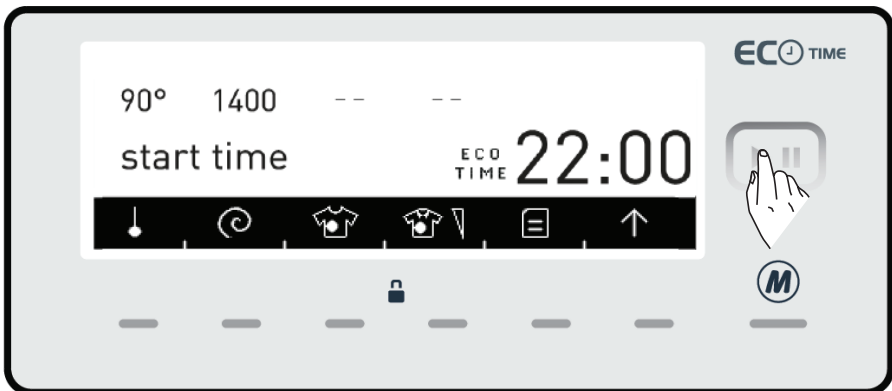

- If you don't want to run the program you have selected between the Eco Time hours, touch the  button again. "Eco Time cancelled" text will be displayed on the screen.

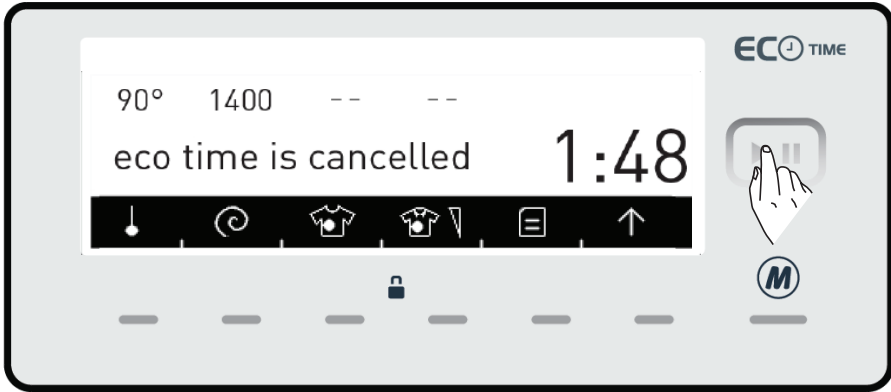

- Your machine will return to the main screen of the program you have selected in 3 seconds. To start the program, run the program you selected by touching the start/stand-by button.

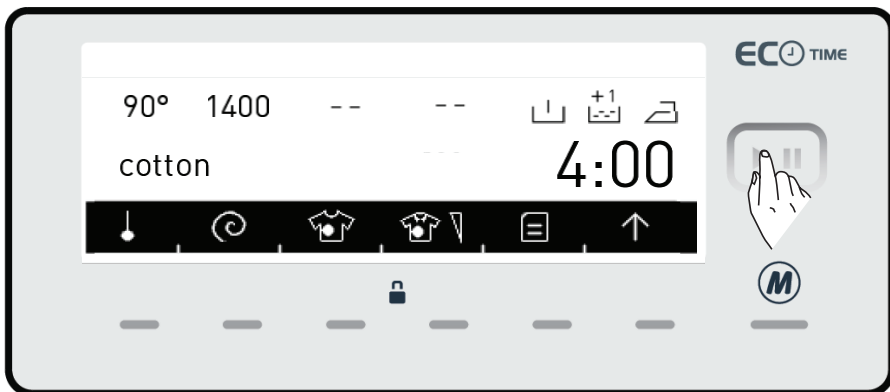



- By using this function, you can make your machine start the washing operation delayed from 10 minutes to 23 hours 50 minutes or you can set according to the hour you want it to end.
- To activate this additional function, touch the button of  symbol.

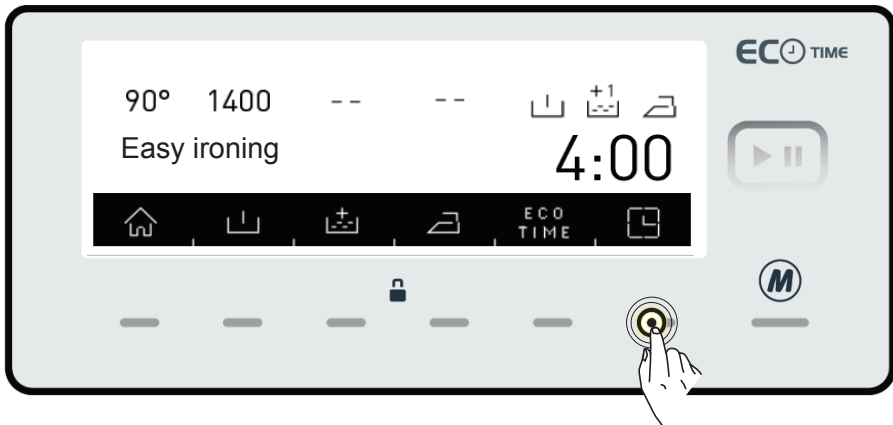

- Current time shall be displayed on the screen for a short duration.

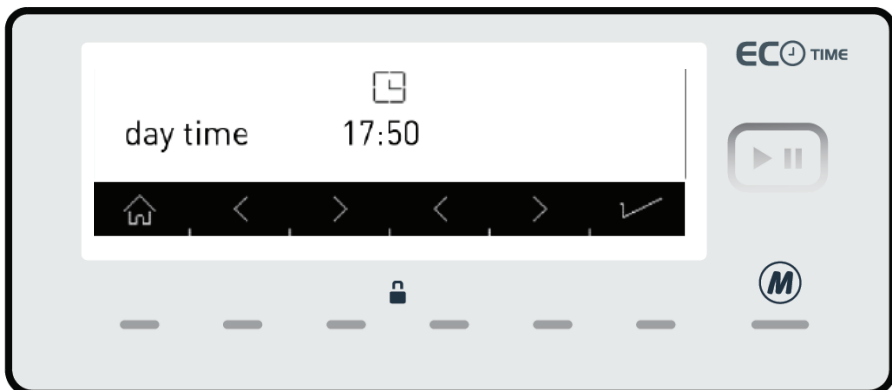



- The screen that shows current time will automatically turn into the screen that displays time delay / program end time.
- On this screen you can use the buttons of < > symbols to delay the washing time, or make the washing operation end at a certain hour.

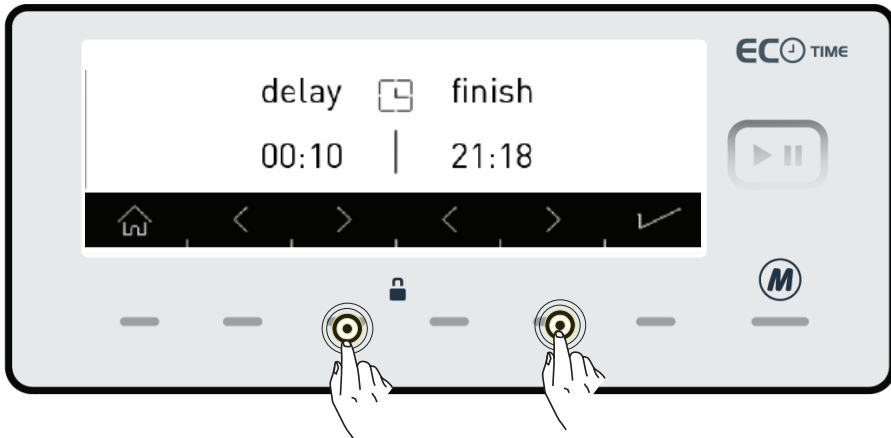

**Note:** The current adjustment of your machine must be made to be able to use this function correctly. See page 36 if you haven't made current time setting.

With this feature in your machine, you can record the washing program settings you have used before by touching a single button, without consuming your time into 2 different memory options. So you can wash your laundry without having to make these settings again. Select the settings you want stored in the memory programs and touch the memory record button.

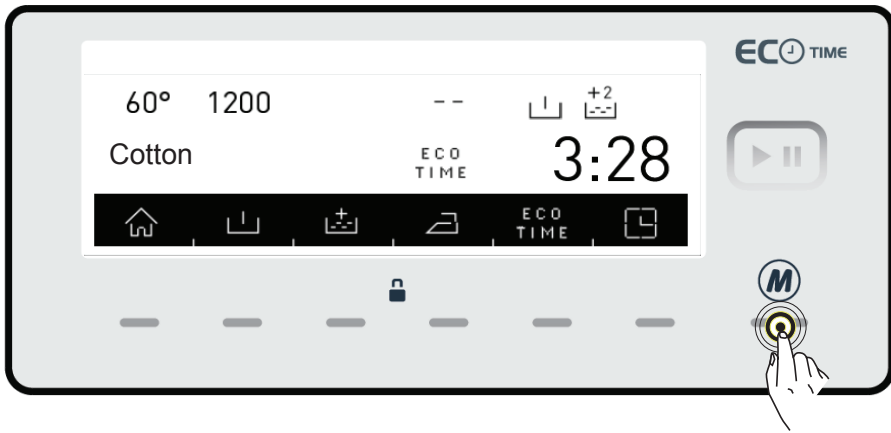

- When you touch the memory button, “Save as memory” question will be displayed on the screen.
- If you want to make changes on the washing programs again before recording, you can go into the program menu by touching the X symbol button.



- When you make the changes you want, you can touch the memory button again.

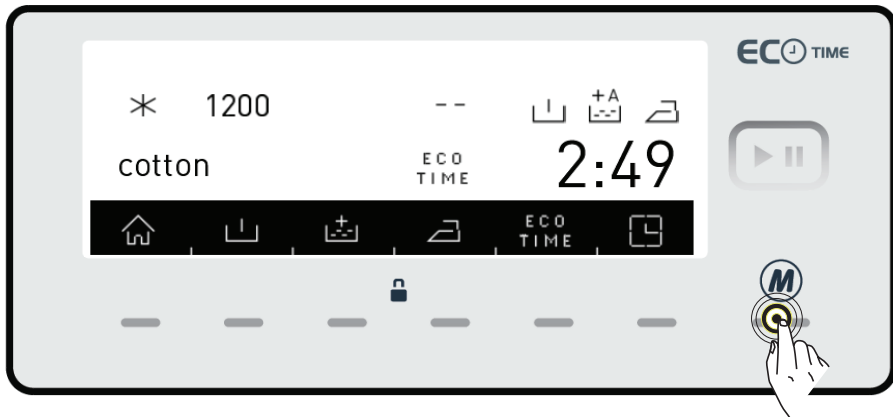

- The question of “Save as memory?” question will be displayed on the screen.

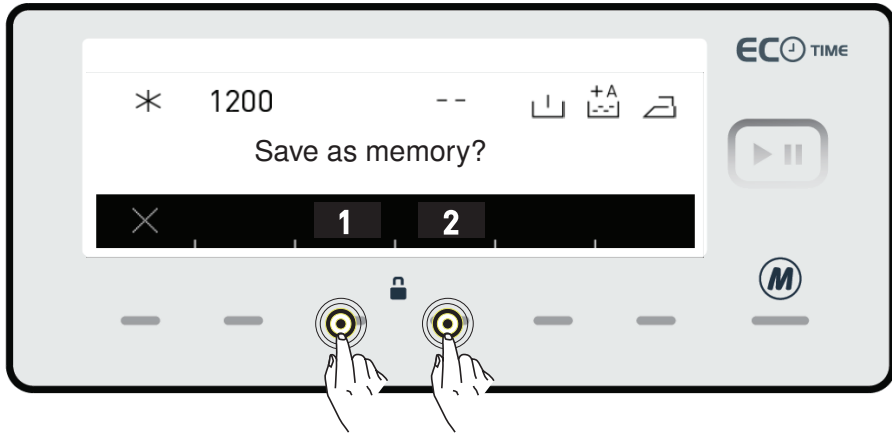

- You can record by touching 1 (Memory 1) or 2 (Memory 2) Memory option buttons

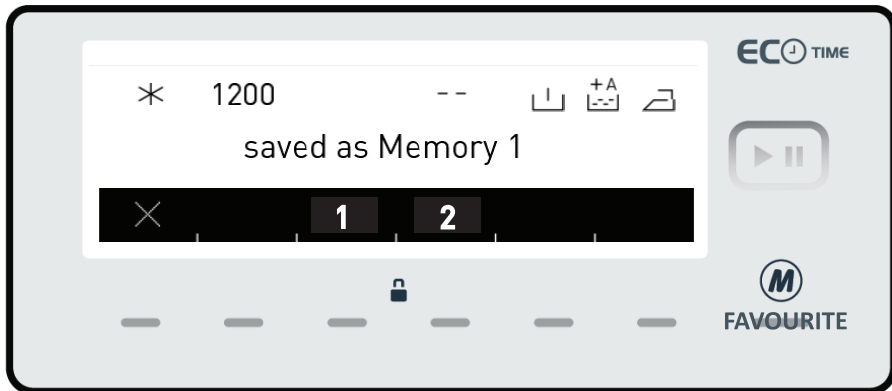

- A screen display like the one above will be displayed when the record is completed and your machine will automatically return to the main screen of the washing program you have made the settings for.

•To wash, you can have your laundry washed by pressing start/stand-by button or select other programs.

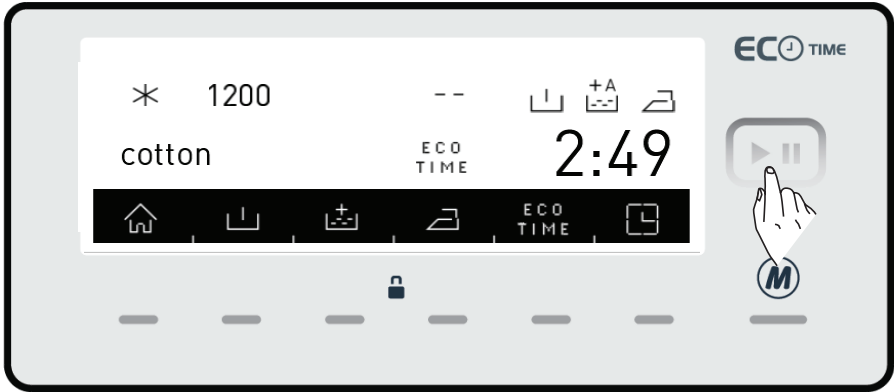

• If you want to use these programs you have recorded, you can turn the program knob as shown in the Picture below and make your selection by moving on the memory steps.

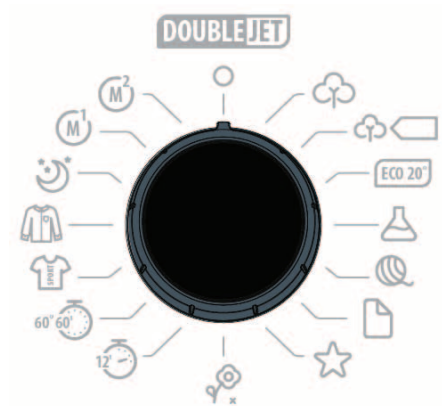
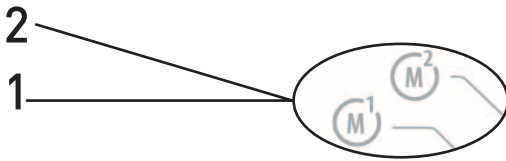

- When you want to change the settings you recorded in memory programs; navigate over the 1 (Memory 1) or 2 (Memory 2) program or while over any program, set the program combination you will select and press the (MEMORY) button.

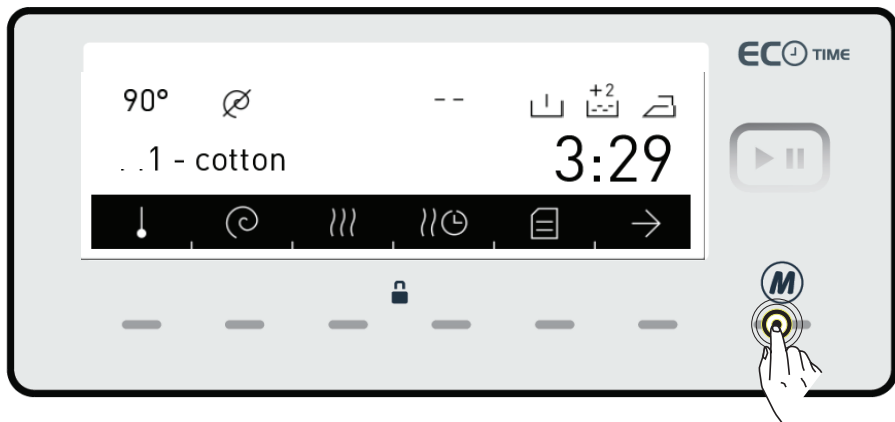

- You will be asked to record by touching 1 (Memory 1), 2 (Memory 2) memory option buttons.

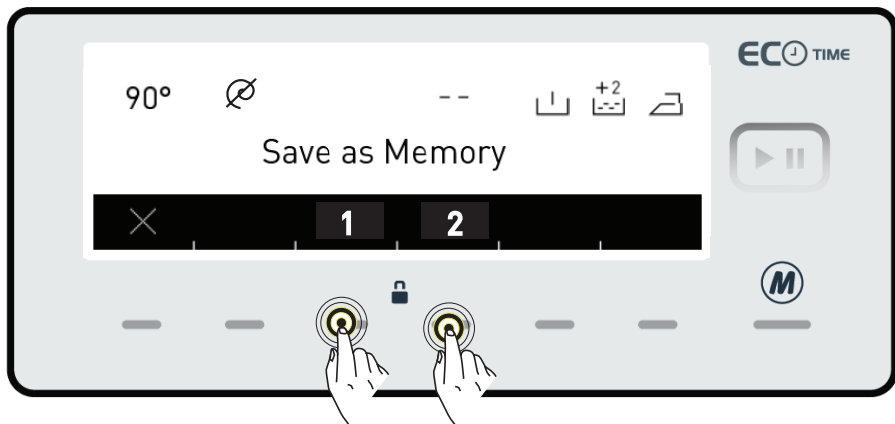

- If you are recording 1(Memory 1), 2(Memory 2) on a program you haven't taken into memory before, a screen like the one below will be displayed.
- Complete the selection by using the memory button you want.

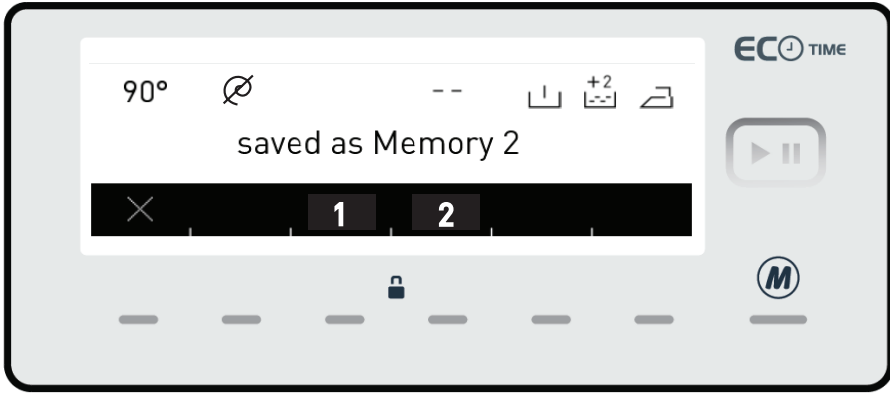

- If you are going to memory on the program you have memory before; you will be asked whether you want to change your previous record or not.
- If you accept, touch the ✓ symbol button.



- Another image will be displayed on the screen for you to approve your selection. You can approve your selection by pressing the ✓ button.

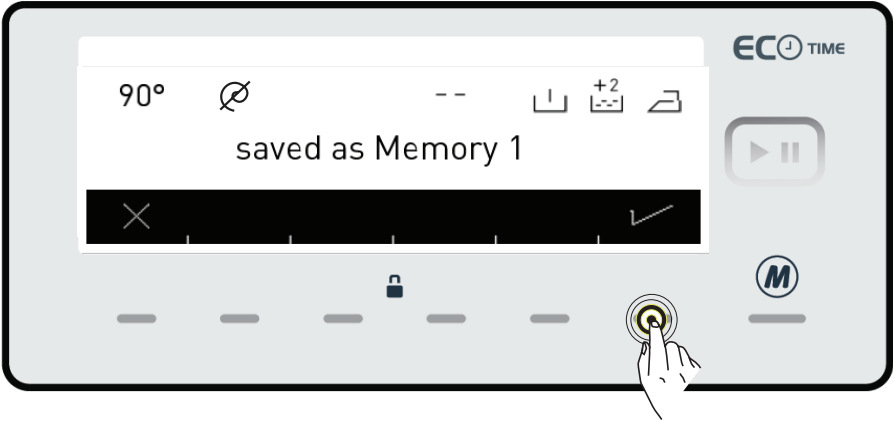





- You can start the program you have selected by touching the Start/Stand-by button .
- When you turn your machine on, the program you have selected will be activated. Throughout the washing operations the washing step screens as the examples below will be displayed.



- Washing program ready washing

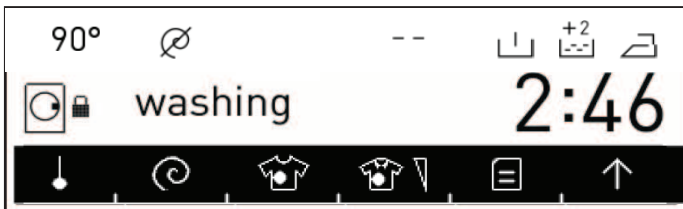

- Washing program active.



- Washing step.



- Rinsing step.



- Wringing step.



- Program finished.



- Program finished door unlocked.

• You can pause or restart the program you have selected with the  button. You can use this function when you want to add laundry to your machine.

\* Touch the  symbol button for this.

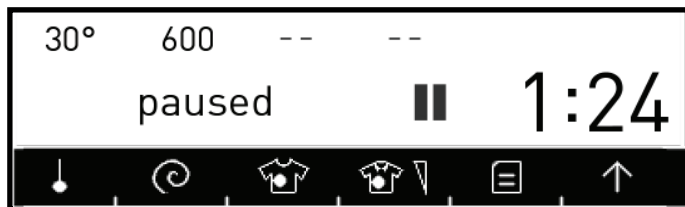

• Washing stopped.

• If the  symbol is displayed on the screen, you can open the door of your machine to add more laundry.

• If the  symbol is displayed on the screen your machine has passed the laundry adding step.

If you want to cancel any program running:

- Switch the program button to the STOP position.
- Your machine will stop the washing operation and the program will be cancelled.
- To discharge the water accumulated in the machine switch the program knob to any program.
- Your machine will perform the necessary discharge operation and cancel the program.
- You can run your machine by selecting a new program.

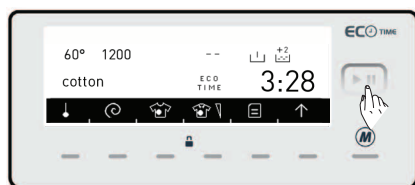

• You can see page (81) program table for program features.

Your machine will stop by itself as soon as the program you have selected finishes.



-“END“ is displayed on the screen.

You can open the machine’s door and remove the laundry.

- Leave the door of your machine open to allow the inner part of your machine to dry after removing your laundries.
- Switch the program knob to the STOP position.
- Unplug your machine.
- Turn the water faucet off.



To avoid program flow from being affected if function buttons are pressed or the program knob is turned when performing a washing operation in your machine, a child lock is available.

The child lock engages after both of the buttons next to the symbol are pressed for more than 3 seconds.

The following warning text will be displayed after the key lock activated.

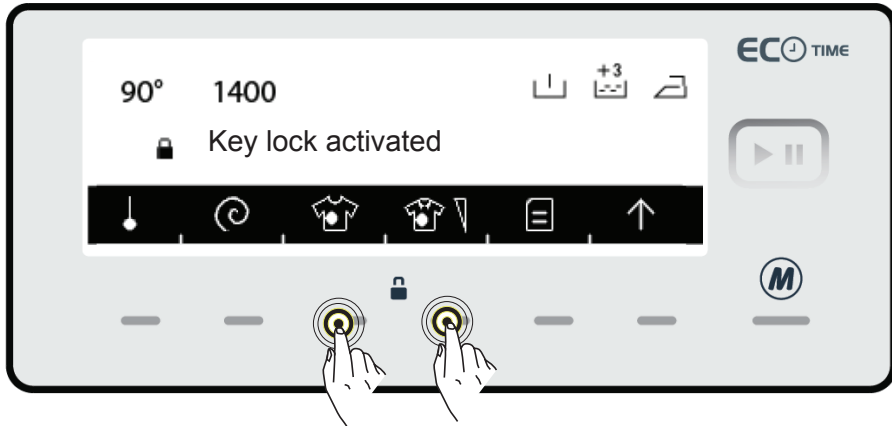

The following text will be displayed if any buttons are pressed while the child lock is engaged.

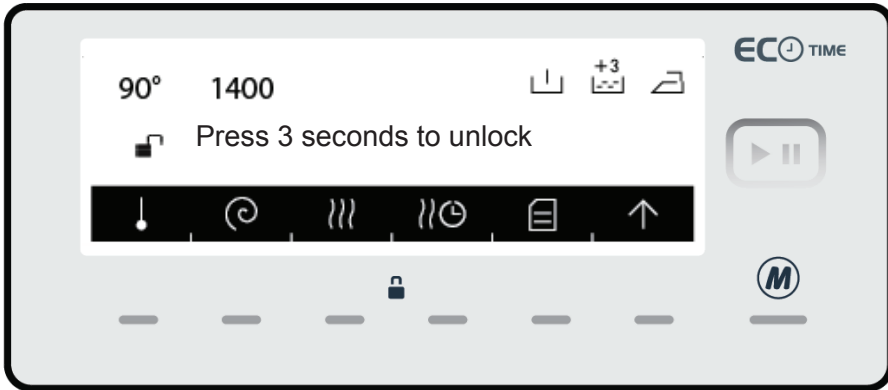

If the child lock is engaged while any program is running and the program knob is switched to the STOP position and another program is selected, the program previously selected continues from where it left.

To disengage the child lock, it will be required to press on the buttons for more than 3 seconds. The | · | · | warning text will be displayed after the child lock disengages.

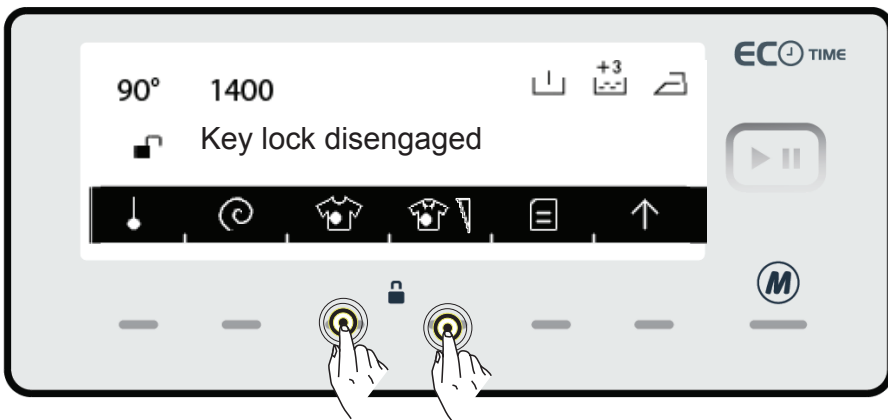

**Note:** Child lock cannot lock the pump cover and detergent drawer of your machine.

Your machine features a half-load detection system.

In case you put approximately half or less amount of laundries of maximum laundry capacity in your machine, your machine will run so as to save washing time, water consumption and energy in some programs. When the half-load function is active, the machine can complete the program you have set in a shorter time.

Detergent water in your machine will be circulated with 2 water injection mechanisms and a mixing system via *Doublejet* system. Circulated detergent water will be injected over your laundries, which allows a better washing performance.

*Doublejet* system will help you wash higher amount of laundries in a shorter time with a better washing performance, guaranteeing less energy and water consumption.

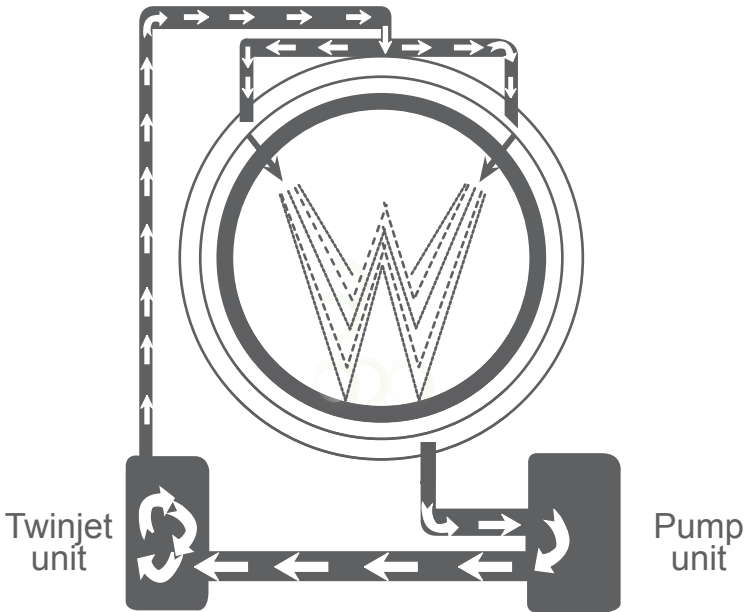



## COTTON 90°

Washing temperature (°C)	*90°-80°-70°-60°-50°-40°-30°-“--”
Maximum dry laundry amount	9,0
Detergent Compartment	2
Program duration (Min.)	190
Laundry type / Explanations	Very dirty, cotton and flax textiles. (Underwear, bedsheet, tablecloth, (towel maximum 4,5 kg), quilt cover rtc.)

## COTTON ECO



Washing Temperature (°C)	*◁60°e - 60°- ▷40°e - 40°- 30°- “--”
Maximum dry laundry amount (kg)	9,0
Detergent compartment	2
Program duration (Min.)	200
Laundry type / Explanations	Dirty, cotton and flax textiles. (Underwear, bedsheet, tablecloth, (towel maximum 4,5 kg), quilt cover rtc.)

\*◁60°e - ▷40°e Energy label declaration programs.

(\*Black parts are factory preset)

**NOTE: PROGRAM DURATION MIGHT CHANGE ACCORDING TO THE AMOUNT OF LAUNDRY, TAP WATER, AMBIENT TEMPERATURE AND SELECTED ADDITIONAL FUNCTIONS.**

## ECO 20°

Washing temperature (°C)	*20°-"-"
Maximum dry laundry amount (kg)	4,5
Detergent compartment	2
Program duration (Min.)	103
Laundry type / Explanations	Little dirty, sweaty, cotton and flax textiles. (Underwear, bedsheet, tablecloth, (towel maximum 2 kg.) bedcloth, etc.)

(\***Black** parts are factory preset)

**NOTE: PROGRAM DURATION MIGHT CHANGE ACCORDING TO THE AMOUNT OF LAUNDRY, TAP WATER, AMBIENT TEMPERATURE AND SELECTED ADDITIONAL FUNCTIONS.**

SYNTHETICS ↘

Washing temperature (°C)	*40°-30°-”-”
Maximum dry laundry amount (kg)	3,5
Detergent compartment	2
Program duration (Min.)	88
Laundry type / Descriptions	Very dirty or synthetic-mixed textiles. (Nylon stockings, shirts, blouses, trousers with synthetic content etc.)

SYNTHETICS  
CURTAIN ↘

Washing temperature (°C)	*40°-30°-”-”
Maximum dry laundry amount (kg)	2,5
Detergent compartment	1&2
Program duration (Min.)	131
Laundry type / Descriptions	Please wash only curtains in this program.

(↘) Synthetic and curtain programs are programs with sub-options, you can see the sub-programs chapter to make a selection.

(\*Black parts are factory preset)

**NOTE: PROGRAM DURATION MIGHT CHANGE ACCORDING TO THE AMOUNT OF LAUNDRY, TAP WATER, AMBIENT TEMPERATURE AND SELECTED ADDITIONAL FUNCTIONS.**

## WOOL ↘

Washing temperature (°C)	*30°- "--"
Maximum dry laundry amount (kg)	2,5
Detergent compartment	2
Program duration (Min.)	53
Laundry type / Descriptions	Woolen laundries with machine wash labels.

## SILK ↘

Washing temperature (°C)	*30°- "--"
Maximum dry laundry amount (kg)	2,5
Detergent compartment	2
Program duration (Min.)	102
Laundry type / Descriptions	Laundry recommended for hand wash or sensitive laundry.

(↘) Wool and Silk programs are programs with sub-options, you can see the sub-programs chapter to make a selection.

(\*Black parts are factory preset)

**NOTE: PROGRAM DURATION MIGHT CHANGE ACCORDING TO THE AMOUNT OF LAUNDRY, TAP WATER, AMBIENT TEMPERATURE AND SELECTED ADDITIONAL FUNCTIONS.**

## DUVET

Washing temperature (°C)	*40° - 30° "--"
Maximum dry laundry amount (kg)	2,5
Detergent compartment	2
Program duration (Min.)	98
Laundry type / Descriptions	You can wash fiber quilts that have machine washable label with this program. (max.2.5 kg)

(\***Black** parts are factory preset)

**NOTE: PROGRAM DURATION MIGHT CHANGE ACCORDING TO THE AMOUNT OF LAUNDRY, TAP WATER, AMBIENT TEMPERATURE AND SELECTED ADDITIONAL FUNCTIONS.**

## RINSE

Washing temperature (°C)	*“_”
Maximum dry laundry amount (kg)	9,0
Detergent compartment	2
Program duration (Min.)	47
Laundry type / Descriptions	If you want to additionally rinse your laundries upon completion of washing operation, you may use this program for any kind of laundries.

## SPIN

Washing temperature (°C)	*“_”
Maximum dry laundry amount (kg)	9,0
Detergent compartment	-
Program duration (Min.)	17
Laundry type / Descriptions	When you want to make an additional spinning to your laundry after the washing step, you can use this programme for all kinds of laundry.

(\*Black parts are factory preset)

**NOTE: PROGRAM DURATION MIGHT CHANGE ACCORDING TO THE AMOUNT OF LAUNDRY, TAP WATER, AMBIENT TEMPERATURE AND SELECTED ADDITIONAL FUNCTIONS.**

## DRAIN

Washing temperature (°C)	-
Maximum dry laundry amount (kg)	9,0
Detergent compartment	-
Program duration (Min.)	3
Laundry type / Descriptions	It makes the water inside the machine to be discharged.

## DRUM CLEAN

Washing temperature (°C)	-
Maximum dry laundry amount (kg)	-
Detergent compartment	-
Program duration (Min.)	90
Laundry type / Descriptions	It is washing drum cleaning programme. It must be used without laundry.

(\*Black parts are factory preset)

**NOTE: PROGRAM DURATION MIGHT CHANGE ACCORDING TO THE AMOUNT OF LAUNDRY, TAP WATER, AMBIENT TEMPERATURE AND SELECTED ADDITIONAL FUNCTIONS.**

## ALLERGY SAFE

Washing temperature (°C)	*60-50-40-30°-"-"
Maximum dry laundry amount (kg)	9,0
Detergent compartment	2
Program duration (Min.)	218
Laundry type / Descriptions	Baby clothes

## RAPID 12 MIN.

Washing temperature (°C)	*30°-"-"
Maximum dry laundry amount (kg)	2,0
Detergent compartment	2
Program duration (Min.)	12
Laundry type / Descriptions	You can wash your slightly stained, cotton, coloured and flax textile within only 12 minutes.

As the washing period is short in this program, less amount of detergent is required to be used compared to other programs. The program period will increase if your machine detects instable loading. You can open the door of your washing machine just after the washing operation is complete.

(\***Black parts are factory preset**)

**NOTE: PROGRAM DURATION MIGHT CHANGE ACCORDING TO THE AMOUNT OF LAUNDRY, TAP WATER, AMBIENT TEMPERATURE AND SELECTED ADDITIONAL FUNCTIONS.**



## DAILY 60° 60'

Washing temperature (°C)	*60°-50°-40°-30°-”--”
Maximum dry laundry amount (kg)	4,0
Detergent compartment	2
Program duration (Min.)	60 / 30
Laundry type / Descriptions	You can wash your dirty cotton, colour and flax textiles at 60°C in 60 minutes.

\* *Daily 60 min. program can wash your laundry in 30 mins according to the dirtiness level selected.*

*If you want your laundry to be washed in 30 minutes, you should select “little dirty” as the dirtiness level. (See page 55)*

## SPORTSWEAR

Washing temperature (°C)	*30°-”--”
Maximum dry laundry amount (kg)	3,5
Detergent compartment	2
Program duration (Min.)	83
Laundry type / Descriptions	Sportswear.

(\***Black** parts are factory preset)

**NOTE: PROGRAM DURATION MIGHT CHANGE ACCORDING TO THE AMOUNT OF LAUNDRY, TAP WATER, AMBIENT TEMPERATURE AND SELECTED ADDITIONAL FUNCTIONS.**

## BLOUSES/SHIRTS

Washing temperature (°C)	*60-50-40-30°-”--”
Maximum dry laundry amount (kg)	4,0
Detergent compartment	2
Program duration (Min.)	120
Laundry type / Descriptions	Dirt, cotton, synthetics and synthetic mix shirts and blouses can be washed together.

(\*Black parts are factory preset)

**NOTE: PROGRAM DURATION MIGHT CHANGE ACCORDING TO THE AMOUNT OF LAUNDRY, TAP WATER, AMBIENT TEMPERATURE AND SELECTED ADDITIONAL FUNCTIONS.**

## NIGHT WASH

Washing temperature (°C)	*90°-80°-70°-60°-50°-40°-30°-”--”
Maximum dry laundry amount (kg)	9,0
Detergent compartment	2
Program duration (Min.)	182
Laundry type / Descriptions	Very dirty, cotton and flax textiles. (Underwear, linen, tablecloth, (towel maximum 4.5 kg), bedclothes, etc.)

**NOTE:** Night washing program is a program that will wash your laundry silently without any wringing stage during the washing. When your machine nears the end of the washing operation, it goes into sleep mode and can keep your laundry for a maximum of 10 hours without discharging the water inside. If the program waiting duration exceeds 10 hours, your machine will automatically perform water discharge and wringing operations. Starting from the time your machine goes into this waiting operation, you can cancel this operation and resume the washing program from where it is left. What you have to do is only to touch the Start / Standby button again. (In sleep mode, the remaining time is not calculated on the display, the remaining time on the display is the duration valid only for discharge and wringing operation.

(\*Black parts are factory preset)

**NOTE: PROGRAM DURATION MIGHT CHANGE ACCORDING TO THE AMOUNT OF LAUNDRY, TAP WATER, AMBIENT TEMPERATURE AND SELECTED ADDITIONAL FUNCTIONS.**

When you select the **synthetics** program from the program knob, you will see two sub-program options.

- 1-Synthetics
- 2-Curtain

• You can make the sub-program selections by pressing the buttons of <> symbols.

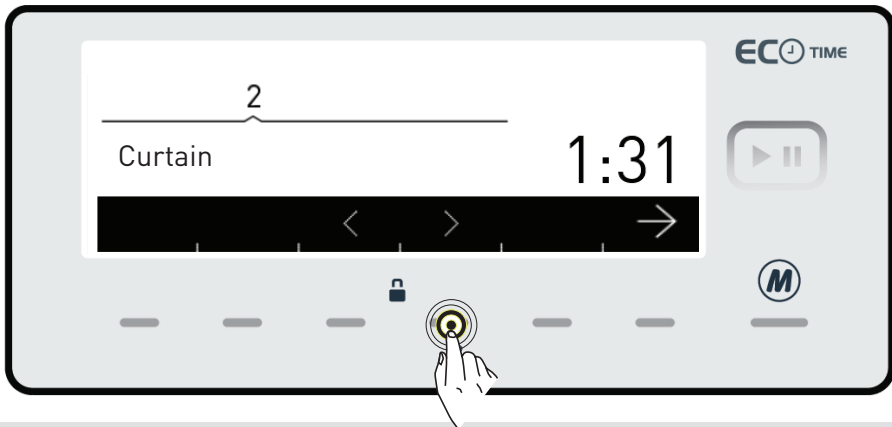
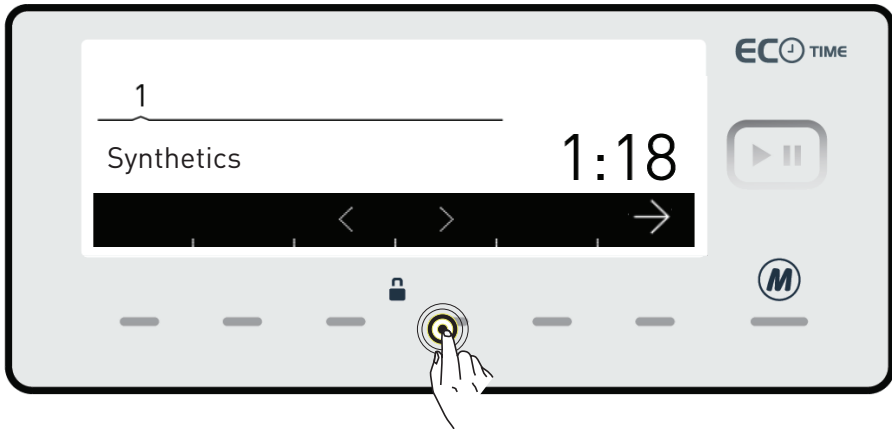
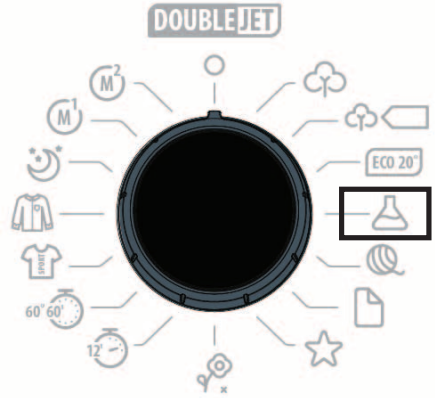

- You can activate the program you want to select by touching the button of the  symbol.

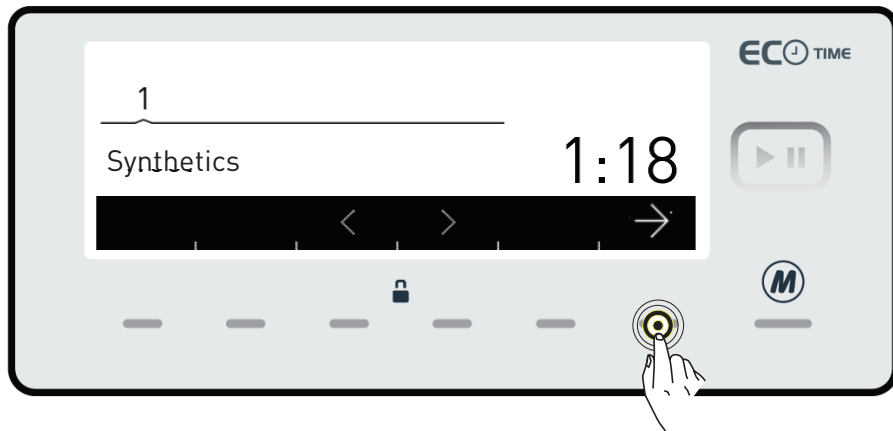

- After the activation is completed the electronic display will return to the main screen of the program you have selected automatically. You can select the other features you want to select on this screen and run the machine by pressing the Start/Stand-by button.

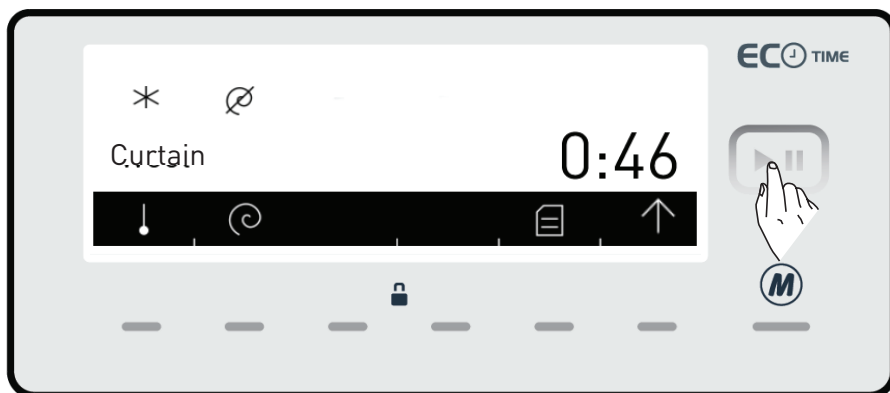

When you select the **wool** program from the program knob, you will see two sub-program options.

- 1-Wool
- 2-Silk

• You can make the sub-program selections by pressing the buttons of < > symbols.

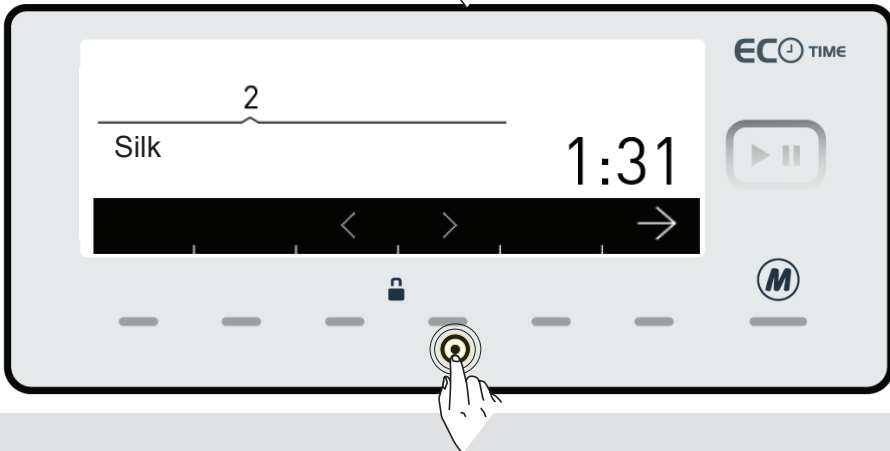
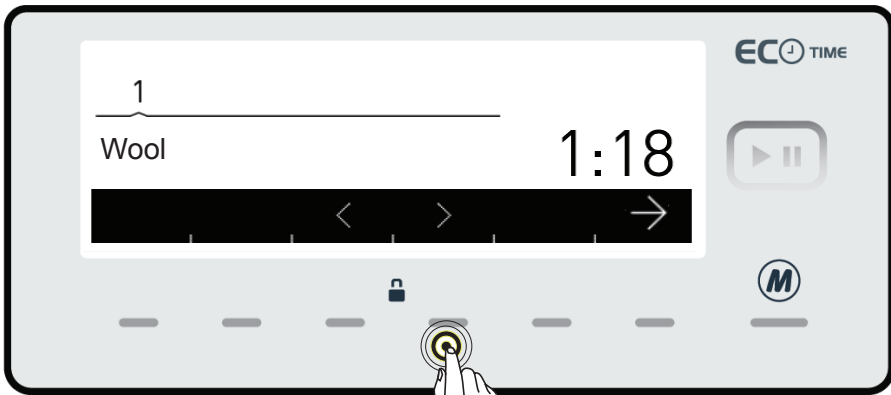
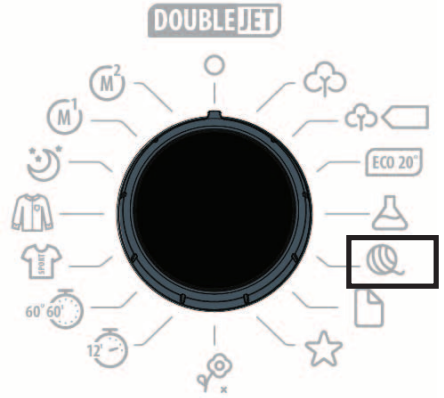

- You can activate the program you want to select by touching the button of the → symbol.

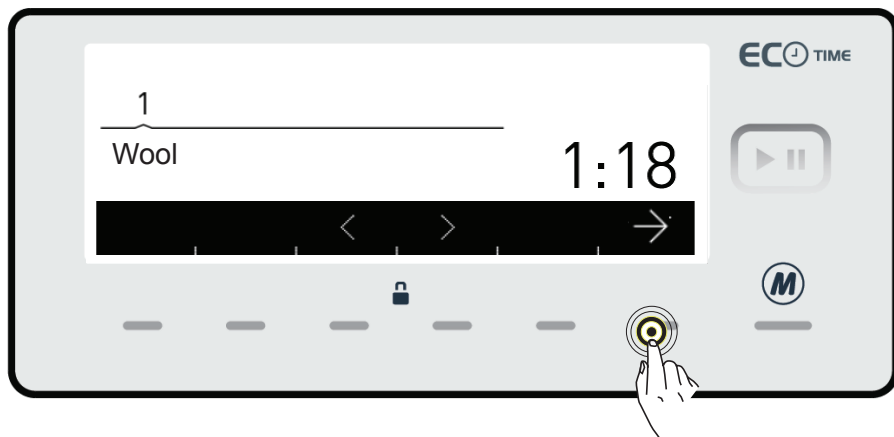

- After the activation is completed the electronic display will return to the main screen of the program you have selected automatically. You can select the other features you want to select on this screen and run the machine by pressing the Start/Stand-by button.

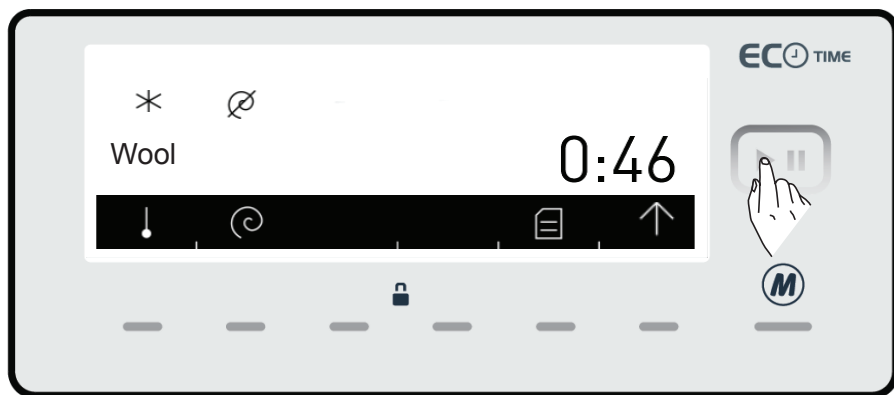

When you select the **extras** program from the program knob, you will see 4 sub-program options.

- 1-Rinse
- 2-Spin
- 3-Drain
- 4-Drum clean

• You can make the sub-program selections by pressing the buttons of <> symbols.

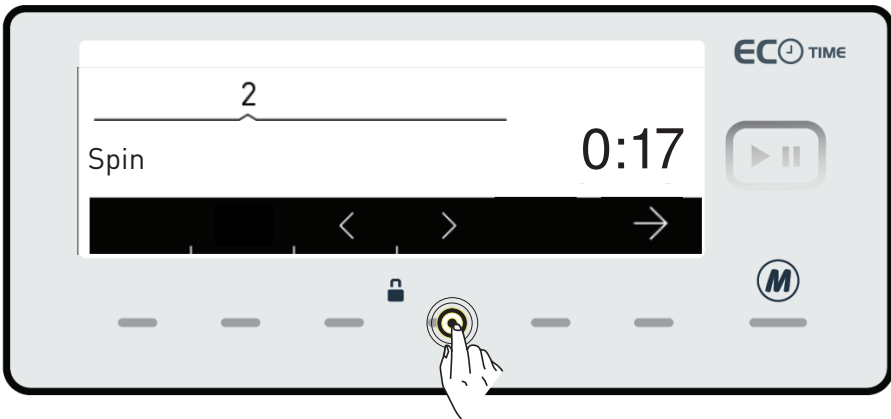
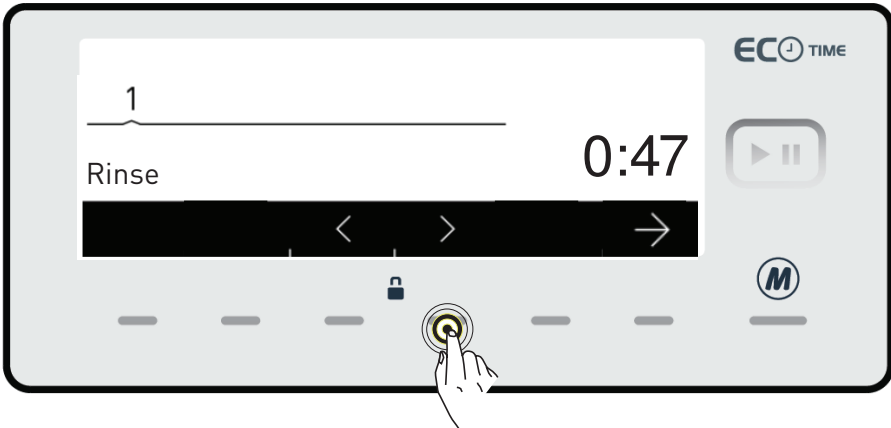
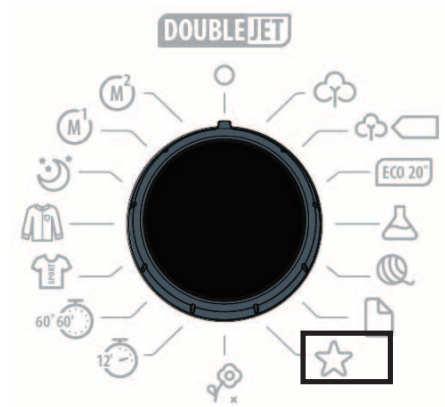



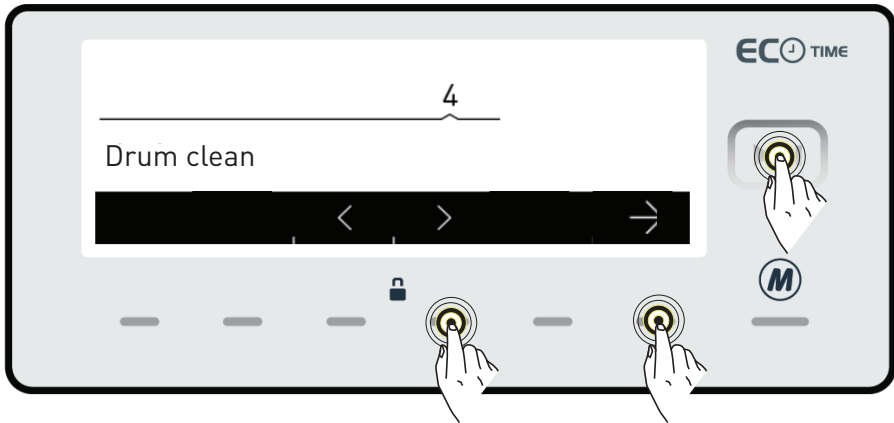
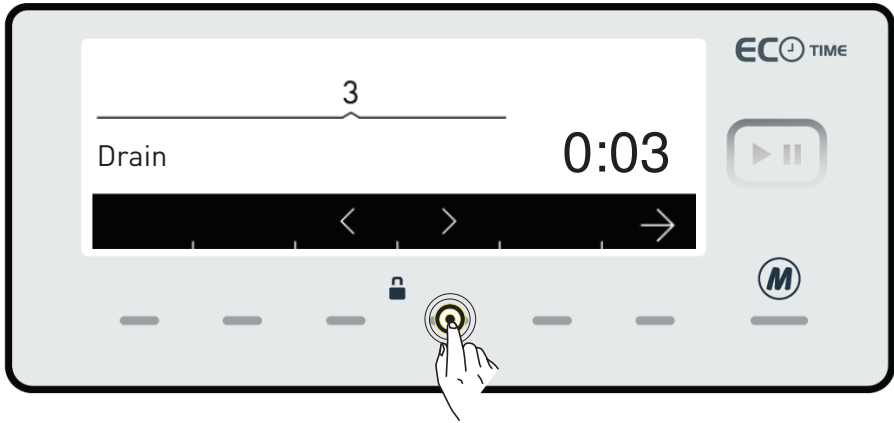

- You can activate the program you want to select by touching the button of the → symbol.
- After the activation is completed the electronic display will return to the main screen of the program you have selected automatically. You can select the other features you want to select on this screen and run the machine by pressing the Start/Stand-by button.

Unplug your machine before starting the maintenance and cleaning of your machine.

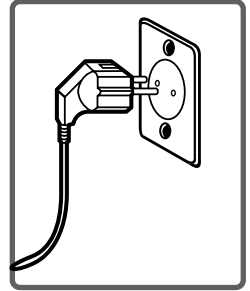

Turn the tap water off before starting the maintenance and cleaning of your machine.

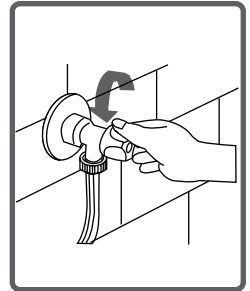

**CAUTION:** Your machine's parts might be damaged if cleaned with solvent agents are used.

**Do not use cleaning materials with solvent agents.**

Filters to avoid dirt and foreign substances in the water from penetrating into the machine are available both on the side of faucet and on the ends of water valves along the water inlet hose of your machine.

If your machine cannot intake sufficient amount of water despite water faucet being open, these filters should be cleaned.

(It is recommended that you clean your pump filter once in 2 months.)

- Detach the water inlet hoses.
- Remove the filters on water inlet valves using pliers and then clean it with a brush in water.
- Disassemble the filters on the side of faucet side of water inlet hoses manually and clean it.
- Having cleaned the filters, you can fit them in the same way reversely.

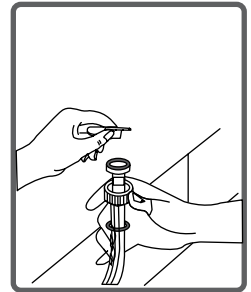
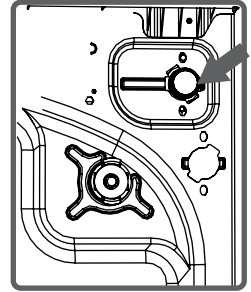

**CAUTION:**

**Filters of water inlet valves may be clogged due to contaminated water faucet or lack of necessary maintenance or valves may be broken down, causing water leaking into your machine continuously.**



**The breakdowns that may arise due to these reasons are out of the scope of warranty.**

A filter system which avoids threads remaining from your laundries and tiny materials from entering into the pump during water discharging operation carried out by your machine after completing washing so prolonging the lifecycle of your pump is available. It is recommended that you clean your pump filter once in 2 months. To clean pump filter:

- To open the pump cover, you can use the powder detergent spade (\*) or liquid detergent level plate coming out of your machine.

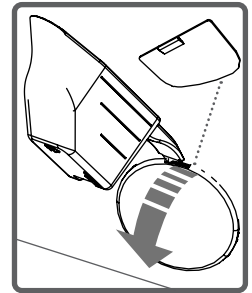

- Fit the end point of the plastic part to the gap of the pump cover and push it back. This will open the cover.

- Before opening the filter cover, settle a vessel in front of the filter cover to prevent the water remained in the machine from flowing on the ground.

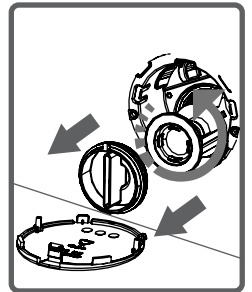

- Loosen the filter cover by rotating counter-clockwise and then empty water.

Note: You may have to empty the water collection vessel several times according to the amount of water in the machine.

(\*) Machinery specifications may vary depending on the product purchased.

- Clean the foreign materials in the filter with a brush.

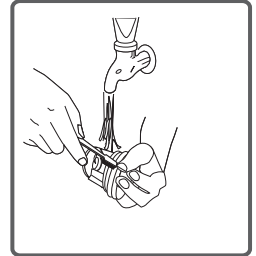

- After cleaning the filter, fit the filter cover and tighten it by rotating it in clockwise direction.

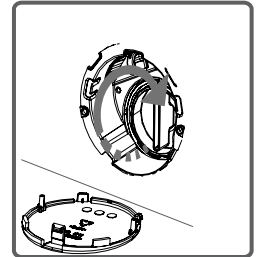

- While closing the pump cover, ensure that the parts on the inner side of the cover to match the holes on the front panel side.

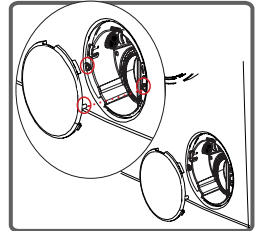

- You can reattach the pump cover in the reverse order that you removed it.

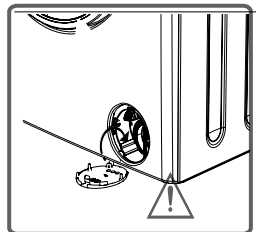

**WARNING!**

As water in the pump may be hot, wait until it cools down.

Your detergents may deposit residue in the detergent drawer and housing of the detergent drawer over time.

To clean the residue formed, disassemble the detergent drawer in particular periods. It is recommended that you clean your pump filter every 2 months.

To eject the detergent drawer:

- Pull the detergent drawer up to the end
- Keep on pulling by depressing on the section shown below in the detergent drawer and keep pulling and then unsettle the detergent drawer.

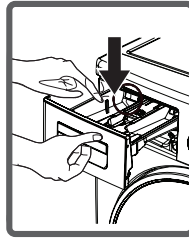
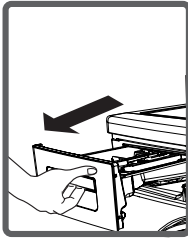

- Flush it using a brush.
- Collect residues in the housing of the detergent drawer without dropping them inside the machine.
- Assemble the detergent drawer after drying it using a towel or dry cloth.
- Do not wash your detergent drawer in dishwasher.



### Liquid Detergent Apparatus (\*)

Take out the liquid detergent level apparatus for cleaning and maintenance purposes as shown in the picture and clean well detergent residues. Put the apparatus back into its place. Make sure no residues are left inside.

(\*) Machinery specifications may vary depending on the product purchased.

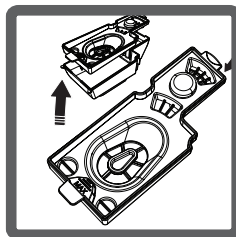
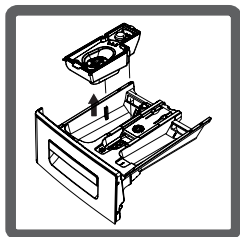

### Flush stopper

Disassemble the detergent drawer. Disassemble the flush stopper and clean the softener residues completely. Refit the flush stopper after cleaning it. Check whether it has settled properly.

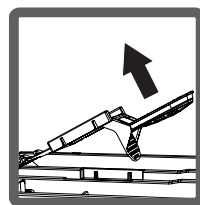
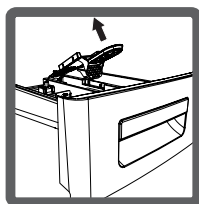
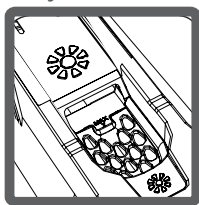

### Body

Clean the outer body of your machine with warm water and a non-inflammable cleaning agent that will not abrade the body of your machine. After rinsing with some water, dry it using a soft and dry cloth.

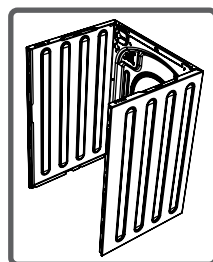

### Drum

Do not leave metallic objects such as needles, paper clips, coins etc. in your machine. These objects lead to the formation of rust stains in the drum. To clean such rust stains, use a non-chlorine cleaning agent and follow the instructions of manufacturers of the cleaning agent. Never use wire wool or similar hard objects for cleaning rust stains.

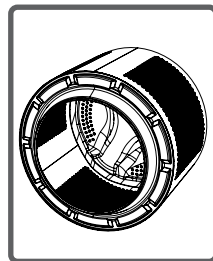

All repairing operations required for your machine should be carried out by our authorised service. If your machine requires a repair or if you cannot remove the fault by the help of the information provided as follows:

- Unplug your machine.
- Turn the water faucet off.

FAULT	POSSIBLE CAUSE	TROUBLE-SHOOTING
Your machine does not start.	It is not plugged.	Plug it.
	Fuse blown.	Replace the fuses.
	Electricity cut-off.	Check mains power.
	Start/pause button not pressed.	Press on Start/ Pause button
	Programme dial 'stop' position.	Switch the programme button to the desired position.
	The machine door is not completely closed.	Close the machine door.
Your machine does not intake water.	Water tap is turned off.	Turn your faucet on.
	Water inlet hose may be twisted.	Check water inlet hose and untwist.
	Water inlet hose clogged.	Clean water inlet hose filters. (*)
	Valve inlet filter clogged.	Clean the valve inlet filters. (*)
	The machine door not completely closed.	Close the machine door.

(\*) See the chapter regarding maintenance and cleaning of your machine.



FAULT	POSSIBLE CAUSE	TROUBLE-SHOOTING
Your machine does not discharge water.	Discharging hose clogged or twisted.	Check the discharging hose, then either clean or untwist.
	Pump filter clogged.	Clean the pump filter. (*)
	Laundry settled in the machine unevenly.	Spread your laundry in the machine evenly.
Your machine vibrates.	The feet of your machine have not been adjusted.	Adjust the feet on your machine. (**)
	Safety stays fitted for transportation not disassembled.	Disassemble the safety stays of your machine. (**)
	Less amount of laundry in the appliance.	This will not block operation of your machine.
	Your machine is overloaded with laundry or laundry settled unevenly.	Do not put in laundry more than the amount recommended and settle the laundry in the machine evenly.
	Your machine rests on a hard surface.	Prevent your machine from resting on hard surfaces.

(\*) See the chapter regarding maintenance and cleaning of your machine.

(\*\*) See the chapter regarding installation of your machine.

FAULT	POSSIBLE CAUSE	TROUBLESHOOTING
Excessive foam is formed in the detergent drawer.	Excessive amount of detergent used.	Press on Start/Pause button To eliminate foam formation, mix a spoon of softener with half litres of water, and pour the mixture in the detergent drawer. After 5-10 minutes, press on Start/Pause button again. In your next washing operation, Adjust the detergent dose accordingly.
	Wrong detergent used.	Use detergents produced only for automatic washing machines in your machine.
Unsatisfactory washing result.	The contamination degree of your laundries does not match the programme you have chosen.	Select the programme appropriate for the contamination degree of your laundries. (See programme table)
	Amount of detergent used insufficient.	Adjust the amount of detergent based on the amount and contamination degree of your laundries.
	Laundries in excess of maximum capacity put in your machine.	Load your machine with laundries, amount of which will not exceed maximum laundry capacity.

FAULT	POSSIBLE CAUSE	TROUBLE-SHOOTING
Unsatisfactory washing result.	Water being hard. (Contaminated, lime water etc.)	Adjust the amount of detergent based on the instruction of detergent manufacturer.
	Laundries distributed in your machine non-homogenously.	Spread your laundries in the machine properly and homogeneously.
As soon as the machine is loaded with water, water discharges.	The end of water discharging hose is too low for the machine.	Set the water discharging hose on appropriate height. (**)
No water appears in the drum during washing.	No fault. Water is in the unseen part of the drum.	—————
Laundries have detergent residues on them.	Non-dissolving particles of some detergents may stick to your laundries as white spots.	Perform an extra rinsing by setting your machine to “Rinsing” programme, or clean the spots using a brush after your laundries dry.
Grey spots appear on the laundries.	The reason for such spots may be oil, cream or ointment.	Apply the maximum amount of detergent instructed by the detergent manufacturer in the next washing operation.

(\*\*) See the chapter regarding installation of your machine.

FAULT	POSSIBLE CAUSE	TROUBLESHOOTING
<p>Spinning operation is not performed or runs late.</p>	<p>No fault. Unbalanced load control system has been activated.</p>	<p>Unbalanced load control system will try to spread your laundries homogeneously. Wringling operation will begin after your laundry is spread. Place the laundry in the machine in a balanced fashion the next time.</p>

Your machine is equipped with the systems which are capable of both taking necessary precautions and warning you in case of any breakdown by means of continuous self-checking during washing operations.

**ERROR CODE**



**POSSIBLE FAULT**

The door of your machine is left open.

**WHAT TO DO**

Close the machine door.  
If your machine persists to indicate fault, turn off your machine, unplug it and contact the nearest authorised service company immediately.

**ERROR CODE**



**WATER CUT OFF**

Check water inlet.





**POSSIBLE FAULT**

Water cut-off or low mains water pressure.

**WHAT TO DO**

- Water tap may be closed. Check.
  - Mains water may be cut-off. Check.
  - If so, switch the programme knob to CANCEL position. You can select a programme and run your machine after the mains water is supplied.
  - Mains water pressure may be low. Check.
  - Water inlet hose may be twisted. Check.
  - Water inlet hose may be clogged.
  - Clean water inlet hose and valve inlet filters.(\*)
- If the problem persists, unplug your machine, turn off your tap and contact the nearest authorised service company.

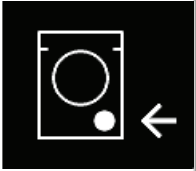
(\* ) See page 99.

<p><b>ERROR CODE</b></p>	<p> <b>PUMP</b></p> <hr/> <p>Unplug the machine</p> 
<p><b>POSSIBLE FAULT</b></p>	<p>The pump is faulty or pump filter is clogged or electrical connection of the pump is faulty.</p>
<p><b>WHAT TO DO</b></p>	<p>Clean the pump(**)filter. If the problem persists, contact the nearest authorised service company.</p>
<p><b>ERROR CODE</b></p>	<p> <b>FILTER</b></p> <hr/> <p>Check the filter.</p> 
<p><b>POSSIBLE FAULT</b></p>	<p>The pump is faulty or pump filter is clogged or electrical connection of the pump is faulty.</p>
<p><b>WHAT TO DO</b></p>	<ul style="list-style-type: none"> <li>- Pump filter may be clogged.</li> <li>- Clean the pump filter. (**)</li> <li>- Drain hose may be clogged or twisted.</li> <li>- Check the Drain hose.</li> <li>- If the problem persists, contact the nearest authorised service company.</li> </ul>

(\*\*) See page 100

**ERROR CODE**



**WATER LEVEL HIGH**

Turn off the tap.



**POSSIBLE FAULT**

Your machine has excessive amount of water.

**WHAT TO DO**

Your machine will drain water by itself. Pursuant to draining operation, turn off your machine and unplug it. Turn off your faucet and contact the nearest authorised service company.



**ERROR CODE**



VOLTAGE



Voltage is high



**ERROR CODE**



VOLTAGE



Voltage low



**POSSIBLE  
FAULT**

Mains voltage is high or low.

**WHAT TO DO**

There might be a fluctuation on the energy fed to your machine, check if the socket you have your machine plugged into is grounded. Have an electrician measure the amount of voltage coming to your house. If there is no problem in the electricity, unplug your machine and inform the nearest service company.

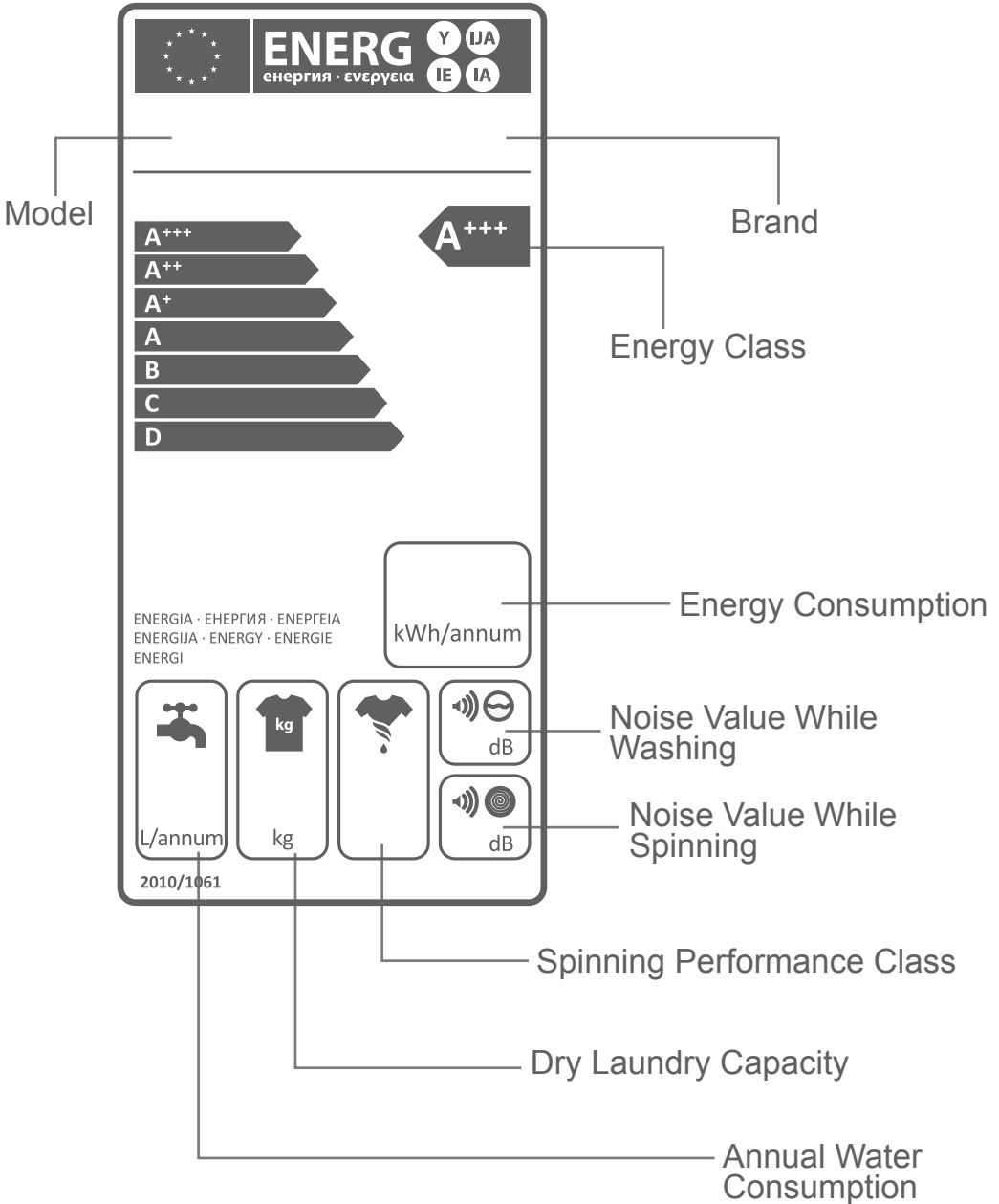

Energy and water consumption may vary based on water pressure, water hardness, water temperature, ambient temperature, laundry amount, additional function selection, voltage fluctuations. It will reduce energy and water consumption to use your machine with the laundry capacity proposed for the selected programme, wash your laundries less dirty or daily laundries in short programmes, carry out cleaning and maintenance periodically, use your machine in convenient time intervals specified by electricity vendor.

This symbol on the product or package implies that the product should not be treated as domestic waste. Instead, it should be delivered to applicable waste collection places recycling electrical and electronic equipment.

You will contribute to avoid potential negative results regarding environment and human health, which will arise due to wrong waste procedure for the product by ensuring that this product is annihilated properly.

Recycling materials will help natural resources be preserved.

For more detailed information regarding recycling of this product, please contact local municipality, domestic waste annihilation service or the shop you have purchased the product.

